



Agenda
Village of Glen Ellyn
Special Village Board Workshop Meeting
Monday, February 23, 2026
6:00 PM
Galligan Board Room

Meeting Procedures Statement

Visitors are most welcome to attend all meetings of the Village Board and can find copies of the Agenda at the meeting or online at www.glenellyn.org prior to the meeting. Any individual with a disability requiring a reasonable accommodation in order to participate in a meeting should contact The Village of Glen Ellyn ADA Coordinator, 630-469-5000, at least five (5) business days in advance of the next scheduled meeting. All matters on the Agenda may be discussed, amended, and acted upon.

- A. Call to Order**
- B. Pledge of Allegiance**
- C. Roll Call**
- D. Audience Participation**

- 1) Open:

Members of the public are welcome to speak to any item not specifically listed on tonight's agenda for up to (3) three minutes. For those items which are on tonight's agenda, the public will have the opportunity to comment when the item is discussed. Please complete the Audience Participation form and turn it in to the Village Clerk. It is requested that one spokesperson for a group be appointed to provide comment for the entire group. When recognized, please step to the microphone and state your name and provide your comment. Individuals wishing to address the Board shall exercise proper decorum and respect for the proceedings and the business of the Village Board, and shall refrain from abusive demeanor and language. The practice of ceding time to other speakers shall be prohibited, except in the discretion of the presiding officer of the meeting. Public officials are not obligated to respond to questions.

- E. Intergovernmental Agreement (IGA) - Village of Glen Ellyn and City of Wheaton Jurisdictional Boundaries**

- 1) Discussion of the Intergovernmental Agreement on Jurisdictional Boundaries with the City Of Wheaton

- F. Adjourn**

Civility Pledge - In the interest of civility, I pledge to promote civility by listening, being respectful of others, acknowledging that we are striving to support and improve our community, and understanding that we each may have different ideas for achieving that objective.



Glen Ellyn Village Board
535 Duane Street
Glen Ellyn, IL 60137

Meeting 2/23/2026 6:00 PM
Department: Administration
Department Head: Mark Franz
Category: Discussion Item
Prepared By: Mark Franz

**AGENDA ITEM (ID
2026-155)**

DOC ID: 2026-155

Discussion of the Intergovernmental Agreement on Jurisdictional Boundaries with the City Of Wheaton

Statement of the Issue:

Staff seeks direction and guidance on the resolution of certain Glen Ellyn/Wheaton boundary jurisdictional conflicts that have been identified by the Village of Glen Ellyn and the City of Wheaton. Most notably, Wheaton College officials have approached both communities to request that the boundary be shifted to the east to allow the entire Wheaton College property to fall within Wheaton. The latest draft of the Intergovernmental Agreement (IGA) between Glen Ellyn and Wheaton has been developed to address these concerns (see attached).

Background

In 1963, the Village of Glen Ellyn and the City of Wheaton established a Planning Boundary Agreement used by both communities as a tool to cooperatively manage the growth occurring in unincorporated land between the two municipalities. In 1979, a formalized boundary line was adopted by both communities through a Boundary Agreement. In 1997, that Boundary Agreement was updated. The most recent Boundary Agreement expired in 2017. Although the 1997 Agreement addressed most of the jurisdictional conflicts, there were a few locations that were not addressed, with one being the Scripture Press property located at the northeast corner of College Avenue and Glencoe Street. The Scripture Press property is made up of a total of nine (9) parcels, shown as "Parcel 1" below. Four (4) of the nine (9) parcels are in Glen Ellyn and five (5) in Wheaton.

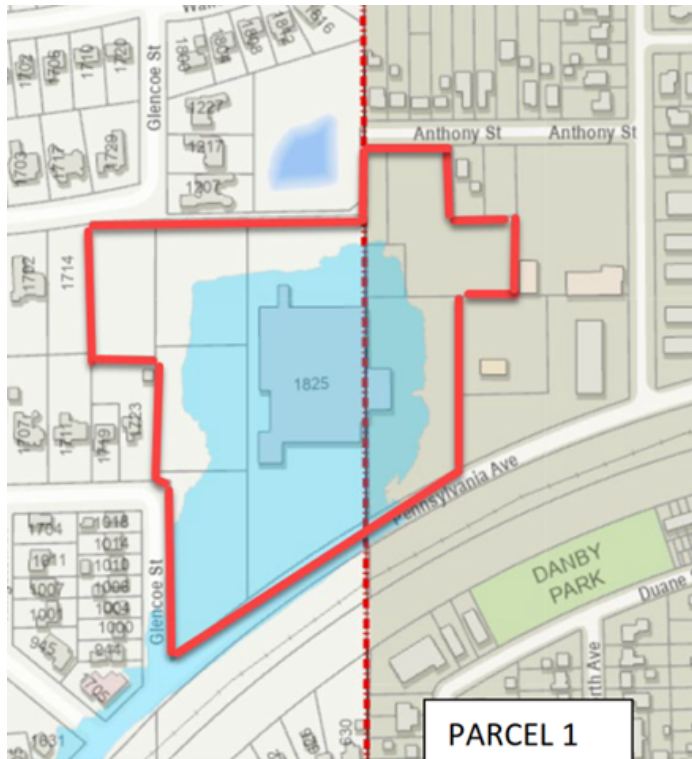

The parcels are currently owned by Wheaton College and College representatives have expressed a desire to consolidate the parcels under one municipal jurisdiction. Wheaton College believes this will be beneficial for redevelopment of the property by providing clarity for utilities, flood plain and storm water regulations, public safety response, and zoning and permitting.

Analysis:

In early discussions between Wheaton and Glen Ellyn staff, it was agreed that the best approach to address Wheaton College’s request was through development of a new Boundary Agreement via an IGA. Over a number of meetings during the last few years, both communities completed a comprehensive review of the 1997 Boundary Agreement and have agreed to basic terms of a modified agreement. This draft IGA was informed by numerous Village Board workshops, meetings with the residents of Anthony Street who live immediately near the Wheaton College property, a stormwater engineering assessment completed by the Village, and engineering assessments performed by a prospective developer.

Intergovernmental Discussions

In 2023, the Village Board discussed the potential IGA with Wheaton with respect to jurisdictional boundaries at two different Village Board workshops on June 20 and October 16. During those discussions, the Village Board directed staff to complete a stormwater assessment of the area around Anthony Street, west of Kenilworth Avenue. The purpose of the study was to better understand the challenges and potential benefits if the Wheaton College property were to be redeveloped in the future. The Village contracted with Engineering Resources Associates (ERA) to perform a stormwater engineering assessment. The scope of work included the following:

- Investigate potential improvements to reduce the depth of ponding in Anthony Street.

- Investigate potential private property improvements to protect homes from flooding.
- Prepare a final technical memorandum summarizing the findings and present them to the public.

ERA completed its report and the Village shared the results with Wheaton, DuPage County, and the neighbors in the Anthony Street area via a meeting in late August 2024. The Glen Ellyn Village Board discussed the proposed IGA, as well as the results of the ERA study, in another workshop session on [September 16, 2024](#). (See link to the 9/16/24 Village Board Workshop). Over the last year, a developer has expressed interest in the property and has used the results of the ERA study to begin its engineering assessment of the property.

With this detailed information, staff has developed more specific terms to incorporate into the final version of the IGA. These provisions are outcome driven, so if the property is developed, then certain stormwater outcomes must be met regardless of the specific developer. The IGA would allow the Glen Ellyn Village Engineer to evaluate and ensure that those stormwater outcomes are included in the final development plans in compliance with the agreement. In addition, both Glen Ellyn and Wheaton have agreed to keep the Anthony Street properties within Glen Ellyn to align more effectively with the existing single-family development along Anthony Street.



The proposed IGA has been vetted and tentatively agreed upon by the respective staff members of both Glen Ellyn and Wheaton.

Potential Development

Over the past year, Wheaton College has been under contract with REVA Development Partners LLC (REVA) to potentially develop the property. Engineering staff from Glen Ellyn, Wheaton, and

DuPage County have utilized the ERA study to advise REVA on its preliminary engineering plan in compliance with the County stormwater ordinance. Representatives from REVA and Village staff met with the Anthony Street neighbors in early February 2026 to share their stormwater plans for the site. Below are some of the engineering findings:

- A portion of the Wheaton College East Campus property lies below the base flood elevation (BFE), which is the elevation that floodwaters are anticipated to reach during a 100-year flood.
- As is, the property provides approximately nine (9) acre-feet of flood storage below the BFE.
- DuPage County's Stormwater Ordinance requires compensatory storage at a ratio of 1.5:1, thus the required compensatory storage is approximately 14 acre-feet.
- The total storage volume of the proposed detention area is 24.55 acre-feet. This includes the required compensatory storage as well as 1.1 acre-feet of storage that has been provided to accommodate the depressional area north of Anthony Street. The balance of the detention pond is planned to accommodate the ordinary retention of a contemplated residential development.
- Proposed improvements to benefit the Anthony Street neighbors include replacing the existing 18" storm sewer at the west end of Anthony Street with a 48" diameter storm sewer capable of conveying the "100-year" storm event to the proposed detention area.
- In addition to the 48" diameter storm sewer, the proposed plan includes an overland drainage path that can convey the 100-year storm event to the detention pond in the event the 48" diameter storm sewer is blocked.

While no official site plan has been shared to date, some preliminary site plan features include:

- Two curb cuts on College Avenue in the vicinity of the existing curb cuts serving the property.
- No vehicular connection to Prairie Avenue or Anthony Street.
- One pedestrian connection at the northwest corner of the site to the existing public walk connecting Anthony and Prairie.
- At least two pedestrian connections to College Avenue.
- Two proposed single-family lots along the south side of Anthony that would remain in Glen Ellyn. These lots would need to be created through the appropriate Village of Glen Ellyn subdivision process.

Intergovernmental Agreement (IGA) Summary

While the discussions with respect to the IGA have focused primarily on the Wheaton College property, there are other aspects included in the updated draft IGA. The key provisions of the draft IGA are as follows:

1. Term: The IGA would have a term of twenty (20) years from the date of execution. The parcels that are disconnected and annexed would remain with their new jurisdictions following the expiration of the IGA.

2. Right-of-Ways: Two areas for right-of-way maintenance clarification have been identified: Ott Avenue and Harwarden Street. These sections of the IGA outline parameters for maintenance responsibility and ownership of utilities.
3. Wheaton College Properties: Section 3 provides for the disconnection of four (4) properties currently in Glen Ellyn from Glen Ellyn, followed by their annexation to Wheaton. Two lots on Anthony would remain in Glen Ellyn. Any development of the Wheaton College property would be required to:
 - Be residential in nature or a use permitted by Wheaton’s current institutional zoning district;
 - Prohibit any roadway connectivity to Anthony Street;
 - Be developed in conformance with the DuPage County Countywide Stormwater and Floodplain Ordinance, as amended by Wheaton;
 - Be developed in such a manner that shall not cause any negative impacts to any downstream and upstream properties and shall lower the 100-year critical duration storm event, or Full Equations (FEQ) Model flood elevation, in Anthony Street to no greater than 756.61;
 - Include construction of an overland drainage path from the lowest top of curb elevation at the west of Anthony Street down into and through Parcel 1;
 - Provide any approved plans to the Glen Ellyn Village Engineer, who shall limit review of the plans to determining whether the plans comply with the requirements of paragraph 3(a)(iv) of the agreement; and
 - Any future Wheaton municipal property tax generated by any development of Parcel 1 shall be shared with Glen Ellyn based upon Parcel 1 equalized assessed value and Wheaton’s annual tax rate. One-third (1/3) of the property tax generated by Parcel 1, if any, shall be remitted to Glen Ellyn no later than August 1st of each year. The obligation to share a portion of the property tax generated by Parcel 1 shall begin when the development of Parcel 1 is completed and all final certificates of occupancy are issued by Wheaton and shall terminate after 20 years of property tax revenues have been paid by Wheaton to Glen Ellyn.

4. Roosevelt/Taft Boundary Line: Two parcels are currently located in Wheaton but are in shared ownership with the property to the east at 285 Roosevelt Rd. in Glen Ellyn. These properties serve as required parking for the retail development anchored by Northwestern Medical. As part of the IGA, these parcels would be disconnected from Wheaton and annexed to Glen Ellyn. The map below (Parcel 2) identifies the two parcels in red.

Next Steps

Staff requests the Village Board’s review of and comment on the IGA. Wheaton is waiting to determine if Glen Ellyn approves the IGA, given that we requested the stormwater study be completed before proceeding with this process. After both elected bodies provide feedback, staff will reconcile the comments for final approval. If the IGA is approved, public hearings will be necessary to complete the disconnections and annexations through a full public review process.

Budget Impact:

If the IGA is approved and the Wheaton College property is developed, the Village of Glen Ellyn would receive 1/3 of the municipal tax generated by the site for 20 years from the date all final Certificates of Occupancy are issued by Wheaton for the development. In addition, the Village of Glen Ellyn would retain the two residential lots on Anthony Street that would contribute to the

property tax base in perpetuity. Lastly, the two parcels on Taft Avenue would pay property taxes to the Village of Glen Ellyn once annexed by the Village.

Contribution to Strategic Plan

Strategic Priority: Development; Strategic Initiative: Successful growth, development, annexation & business retention; Action Item: Consider annexation opportunities to increase the tax base, control future development, share costs of infrastructure, and provide and protect high quality of life for neighborhoods

Action Requested:

Discussion only.

Attachments:

1. Wheaton IGA

**INTERGOVERNMENTAL AGREEMENT BETWEEN THE VILLAGE OF GLEN ELLYN AND THE CITY OF
WHEATON REGARDING JURISDICTIONAL BOUNDARIES**

THIS INTERGOVERNMENTAL AGREEMENT (hereinafter referred to as the “Agreement”) is entered into this ____ day of _____, 2026, by and between the VILLAGE OF GLEN ELLYN, DuPage County, Illinois, an Illinois home rule Municipal Corporation (hereinafter referred to as “Glen Ellyn”) and the CITY OF WHEATON, DuPage County, Illinois, an Illinois home rule Municipal Corporation (hereinafter referred to as “Wheaton”) (The Parties to this Agreement may also be referred to herein as a “Party” and collectively as the “Parties”).

WHEREAS, Glen Ellyn and Wheaton recognize the need to provide for logical municipal boundaries in areas of municipal authority between their respective municipalities; and

WHEREAS, Glen Ellyn and Wheaton are units of local government as defined by Article VII, Section 10 of the Constitution of the State of Illinois; and

WHEREAS, units of local government are enabled by Article VII, Section 10 of the Constitution of the State of Illinois to enter into agreements among themselves to obtain or share services and to exercise, combine, or transfer any power or function, in any manner not prohibited by law or ordinance; and

WHEREAS, the Intergovernmental Cooperation Act, 5 ILCS 220/1 *et seq.*, further authorizes units of local government to jointly exercise any power, privilege, or authority which may be exercised by a unit of local government individually, and to enter into contracts for the performance of governmental services, activities, and undertakings; and

WHEREAS, Glen Ellyn and Wheaton are units of local government under the Intergovernmental Cooperation Act, 5 ILCS 220/2; and

WHEREAS, the Illinois Municipal Code, 65 ILCS 5/11-12-9, provides that municipalities may enter into jurisdictional boundary line agreements (“Boundary Agreement(s)"); and

WHEREAS, Glen Ellyn and Wheaton have given consideration to the natural flow of storm water drainage and single tracts having common ownership within the jurisdictions of Glen Ellyn and Wheaton; and

WHEREAS, Glen Ellyn and Wheaton have previously entered into a Boundary Agreement dated July 16, 1979 and a Boundary Agreement dated January 27, 1997; and

WHEREAS, the January 27, 1997 Boundary Agreement expired on January 27, 2017; and

WHEREAS, Glen Ellyn and Wheaton now desire to reestablish a Boundary Agreement which will supersede the prior two Boundary Agreements and set forth a revised boundary line, west of which Glen Ellyn will not annex and east of which Wheaton will not annex, which will mark the boundary of the jurisdictions of Glen Ellyn and Wheaton except as modified by this Agreement; and

WHEREAS, Glen Ellyn and Wheaton also desire to utilize this Agreement to memorialize and clarify responsibilities for infrastructure along Anthony Street, Ott Avenue, Harwarden Avenue, as well as for

two potable water main interconnections; and

WHEREAS, Glen Ellyn and Wheaton have authorized the execution of this Agreement as an exercise of their respective authority and as an exercise of their intergovernmental cooperation authority under the Constitution of the State of Illinois and the Intergovernmental Cooperation Act.

NOW, THEREFORE, for and in consideration of mutual promises contained herein and upon the further consideration of the recitals hereinabove set forth, it is hereby agreed between Glen Ellyn and Wheaton as follows:

1. **Recitals.** The recitals set forth above are hereby restated and incorporated as if fully set forth herein.
2. **Boundary Maps.** Except as modified in this Agreement and as depicted in pages 1 through 6 of the maps which are collectively attached hereto and made a part hereof as Exhibit A, the jurisdictional boundary line between Glen Ellyn and Wheaton for municipal planning, subdivision control and annexation shall be as depicted in Exhibit A.
3. **Wheaton College Properties.** With respect to the parcels of land lying east of Glencoe Street, west of Kenilworth Avenue, and north of College Avenue/Pennsylvania Avenue, depicted in Exhibit A as "Parcel 1" (hereinafter referred to as "Parcel 1") to permit the orderly development and provision of efficient municipal services including but not limited to public safety, utilities and zoning, it is the desire of the current owner, the Trustees of Wheaton College (hereinafter referred to as "Wheaton College"), to develop Parcel 1 within Wheaton. Wheaton College has expressed interest in filing a petition with the respective municipal clerks requesting Parcel 1, currently within the jurisdiction of Glen Ellyn (P.I.N.s 05-10-408-011, 05-10-408-003, 05-10-408-002, and 05-10-408-020) and owned by Wheaton College, be disconnected from Glen Ellyn as provided for in Section 7-1-24 of the Illinois Municipal Code, 65 ILCS 5/7-1-24, and then annexed to Wheaton. Glen Ellyn shall immediately process such a petition after receipt from Wheaton College in accordance with applicable law. The boundary line of that part of Parcel 1 that is to remain in Glen Ellyn shall be governed by the future disconnection and annexation ordinances. All subdivision level development for Parcel 1 shall be reviewed, approved, and inspected by Wheaton. Any subsequent development of that part of Parcel 1 to remain in Glen Ellyn, shall be reviewed, approved, and inspected by Glen Ellyn.
 - a. Any "development," as defined in the DuPage County Countywide Stormwater and Floodplain Ordinance, of Parcel 1, whether independently or collectively, shall be reviewed and approved by Wheaton. Any development reviewed and approved by Wheaton shall:
 - i. Be residential in nature or a use permitted by Wheaton's current institutional zoning district;
 - ii. Prohibit any roadway connectivity to Anthony Street;
 - iii. Be developed in conformance with the DuPage County Countywide Stormwater and Floodplain Ordinance, as amended by Wheaton;
 - iv. Be developed in such a manner that shall not cause any negative impacts to any downstream and upstream properties and shall lower the 100-year critical duration storm event, or Full Equations (FEQ) Model flood elevation, in Anthony Street to no greater than 756.61 with an acceptable deviation of plus or minus

0.1 feet, North American Vertical Datum 1988 – feet (NAVD88-ft) as depicted in Exhibit B attached hereto and incorporated herein as if fully set forth. Any development of Parcel 1 shall include construction of an overland drainage path from the lowest top of curb elevation at the west of Anthony Street down into and through Parcel 1 as per Wheaton City Code Section 34-99(a) with bridges or open ended box culverts to not be considered storm sewers as per Section 34-99(a). The overland drainage path shall be located within the property to be annexed into Wheaton.; and

- v. Address the stormwater requirements set forth in paragraphs 3(a)(iv). Wheaton shall provide any approved plans to the Glen Ellyn Village Engineer, who shall limit his review to whether the plans comply with the requirements of paragraph 3(a)(iv) above. The Glen Ellyn Village Engineer shall review said plans and provide approval or disapproval to Wheaton within sixty (60) days of receipt of the plans. If he fails to do so, the plans shall be considered approved.
 - b. Any future Wheaton municipal property tax generated by any development of Parcel 1 shall be shared with Glen Ellyn based upon Parcel 1 equalized assessed value and Wheaton’s annual tax rate. One-third (1/3) of the property tax generated by Parcel 1, if any, shall be remitted to Glen Ellyn no later than August 1st of each year. The obligation to share a portion of the property tax generated by Parcel 1 shall begin when the development of Parcel 1 is completed and all final certificates of occupancy are issued by Wheaton and shall terminate after 20 years of property tax revenues have been paid by Wheaton to Glen Ellyn.
4. **Anthony Street.** West of Kenilworth Avenue, the Anthony Street right-of-way and associated public improvements including the roadway pavement, roadway curb and gutter, public sidewalk, driveway approaches, water main, sanitary sewer, street signage, and public trees contained in the right-of-way in Glen Ellyn shall be the sole responsibility of Glen Ellyn to own, operate, and maintain. The storm sewer structures, pipe, curb and gutter, pavement, and sidewalk around the storm sewer structures draining the west end of Anthony Street as well as the sidewalk at the west end of Anthony Street (and any future storm sewer draining south from Anthony Street through Parcel 1) shall be the sole responsibility of Wheaton to own, operate, and maintain.
5. **Ott Avenue.** The Ott Avenue right-of-way and associated public improvements including the roadway pavement, roadway curb and gutter, public sidewalk, driveway approaches, water main, sanitary sewer, street signage, and public trees contained in Glen Ellyn from a point south of the Harwarden Street/Ott Avenue intersection to a point south of the Evergreen Street/Ott Avenue intersection shall be the sole responsibility of Glen Ellyn to own, operate, and maintain except that the public improvements west of the back of curb on the west side of Ott Avenue including the driveway approaches, public trees, street signage as well as the existing water main owned by Wheaton serving properties within Wheaton adjacent to the Ott Avenue right of way, and the storm sewer in the Ott Avenue right of way including any connecting catch basins shall be the sole responsibility of Wheaton to own, operate and maintain. Glen Ellyn currently plans to construct roadway and utility improvements at Ott Avenue in 2026. As part of Glen Ellyn’s improvement of Ott Avenue, Wheaton shall complete all repairs, replacements, and adjustments of its infrastructure within Ott Avenue. Wheaton also shall fund the construction of sidewalk ramps, including all restoration work, on the west side of Ott Avenue at its intersections with Illinois Street, and East Liberty Drive/Fairview Avenue. Said ramps shall be constructed as part of Glen

Ellyn's Improvement of Ott Avenue and Wheaton shall reimburse Glen Ellyn upon its completion and payment by Glen Ellyn to its Contractor for the work.

6. **Harwarden Street.** That portion of the vacated Harwarden Street thirty-three foot (33') right of way on 200 Lorraine Road, Glen Ellyn, (P.I.N. 05-15-211-039) now exists as a Public Walkway and Utility Easement which grant rights for Wheaton to maintain an existing concrete public sidewalk, storm sewer main and water main on 200 Lorraine Road, Glen Ellyn. As said easement lies on property under Glen Ellyn's jurisdiction, Glen Ellyn shall within its rights assist Wheaton with ensuring the owner of 200 Lorraine Road does not interfere with Wheaton's excise of all necessary work within said easement to maintain the existing water and storm sewer mains as well as the public sidewalk. At the intersection of Lorraine and Harwarden, storm sewer and catch basins serving Lorraine north of Harwarden shall be the responsibility of Glen Ellyn. The public improvements on Harwarden between Lorraine and Ott, including the roadway pavement, roadway curb and gutter, public sidewalk, driveway approaches, water main, street signage, and public trees shall be the responsibility of Wheaton to own, operate, and maintain except those public improvements including the driveway approaches and parkway trees located north of the back of curb on the north side of Harwarden as well as the existing Village of Glen Ellyn water main serving properties within Glen Ellyn adjacent to the Harwarden right of way shall be the responsibility of Glen Ellyn to own, operate, and maintain.
7. **On-Site Parking Facility.** The properties (P.I.N. 05-22-200-028 and P.I.N. 05-22-200-027) on the north side of Taft Avenue, depicted on page 3 of Exhibit A as Parcel 2, currently used as on-site parking for the property (P.I.N. 05-22-201-037) adjacent and east of said properties, shall be disconnected from Wheaton as provided for in Section 7-1-24 of the Illinois Municipal Code, 65 ILCS 5/7-1-24, and then annexed to Glen Ellyn.
8. **Emergency Water Connections.** The Glen Ellyn and Wheaton potable water systems are interconnected at two locations to provide emergency stand by water supplies in the event of system failures in either community. The unmetered interconnections are located at Lorraine and Harwarden and Evergreen and Ott and would be activated only by agreement by the Public Works Directors of both Glen Ellyn and Wheaton.
9. **Planning Jurisdiction.** This Agreement shall not be construed to limit or adversely affect the right of either party to file a statutory objection to a proposed zoning application by DuPage County within one and one-half (1-1/2) miles of its corporate limits.
10. **Terms and Assigns.** This Agreement shall inure to the benefit of and be binding upon the parties, their respective successors and assigns for a term of twenty (20) years or when 20 years of property tax revenue is paid by Wheaton to Glen Ellyn.
11. **Law and Venue.** This Agreement shall be construed in accordance with the laws of the State of Illinois and venue shall only be in the Circuit Court of DuPage County, Illinois.
12. **Recordation.** Wheaton shall record this Agreement with the DuPage County Recorder of Deeds at its own expense.
13. **Invalidity.** If any section, paragraph, subdivision, clause, sentence, or provision of this Agreement shall be adjudged by any court of competent jurisdiction to be invalid, such judgement should not

affect, impair, invalidate, or nullify the remainder thereof, which remainder shall remain and continue to be in full force and effect.

14. **Authorization.** Upon execution of this Agreement by the corporate authorities of Glen Ellyn and Wheaton, the municipal clerk of the respective municipality shall each affix their official seal to this Agreement.
15. **Agreement to be on File.** Copies of this Agreement shall be placed on file with the municipal clerks of Wheaton and Glen Ellyn and shall be made available in the offices of said municipal clerks.
16. **Counterparts.** This Agreement may be executed in counterparts each of which shall be considered an original and together shall be considered one and the same Agreement.
17. **Headings and Titles.** The headings and titles of any provisions of this Agreement are for convenience and reference only and not to be considered in construing this Agreement.
18. **Notice.** Any notice required to be given by this Agreement shall be deemed sufficient if made in writing and sent by certified mail, return receipt requested, by personal service, or by electronic mail to the persons and addresses indicated below or to such other addresses as either party hereto shall notify the other party of in writing pursuant to the provisions of this subsection:

If to Glen Ellyn:

Village Manager
Village of Glen Ellyn
535 Duane Street
Glen Ellyn, Illinois 60137
Email: mfranz@glenellyn.org

If to Wheaton:

City Manager
City of Wheaton
303 West Wesley Street
Wheaton, Illinois 60187
Email: mdzugan@wheaton.il.us

Mailing of such notice as and when above provided shall be equivalent to personal notice and shall be deemed to have been given at the time of mailing. Notice by email transmission shall be effective as of date and time of email transmission, provided that the notice transmitted shall be sent on business days during business hours (9:00 a.m. to 5:00 p.m. Chicago time). In the event email notice is transmitted during non-business hours, the effective date and time of notice is the first hour of the first business day after transmission.

19. **Effective Date.** The effective date of this Agreement shall be the last date of its execution by one of the parties as reflected below.

IN WITNESS WHEREOF, the parties hereto have caused this Agreement to be executed by the Acting Village President of the Village of Glen Ellyn and the Mayor of the City of Wheaton, attested by their respective municipal clerk, and their corporate seal hereunto affixed, as of the day and year first written above.

VILLAGE OF GLEN ELLYN
an Illinois home rule municipality

CITY OF WHEATON
an Illinois home rule municipality

By: _____
James Burket, Village President

By: _____
Phillip J. Suess, Mayor

Date: _____

Date: _____

ATTEST:

ATTEST:

Caren Crosby, Village Clerk

Andrea Rosedale, City Clerk

Date: _____

Date: _____

EXHIBIT A - BOUNDARY MAPS
(following 6 pages)

**City of Wheaton
Boundary Map
Page: 1**

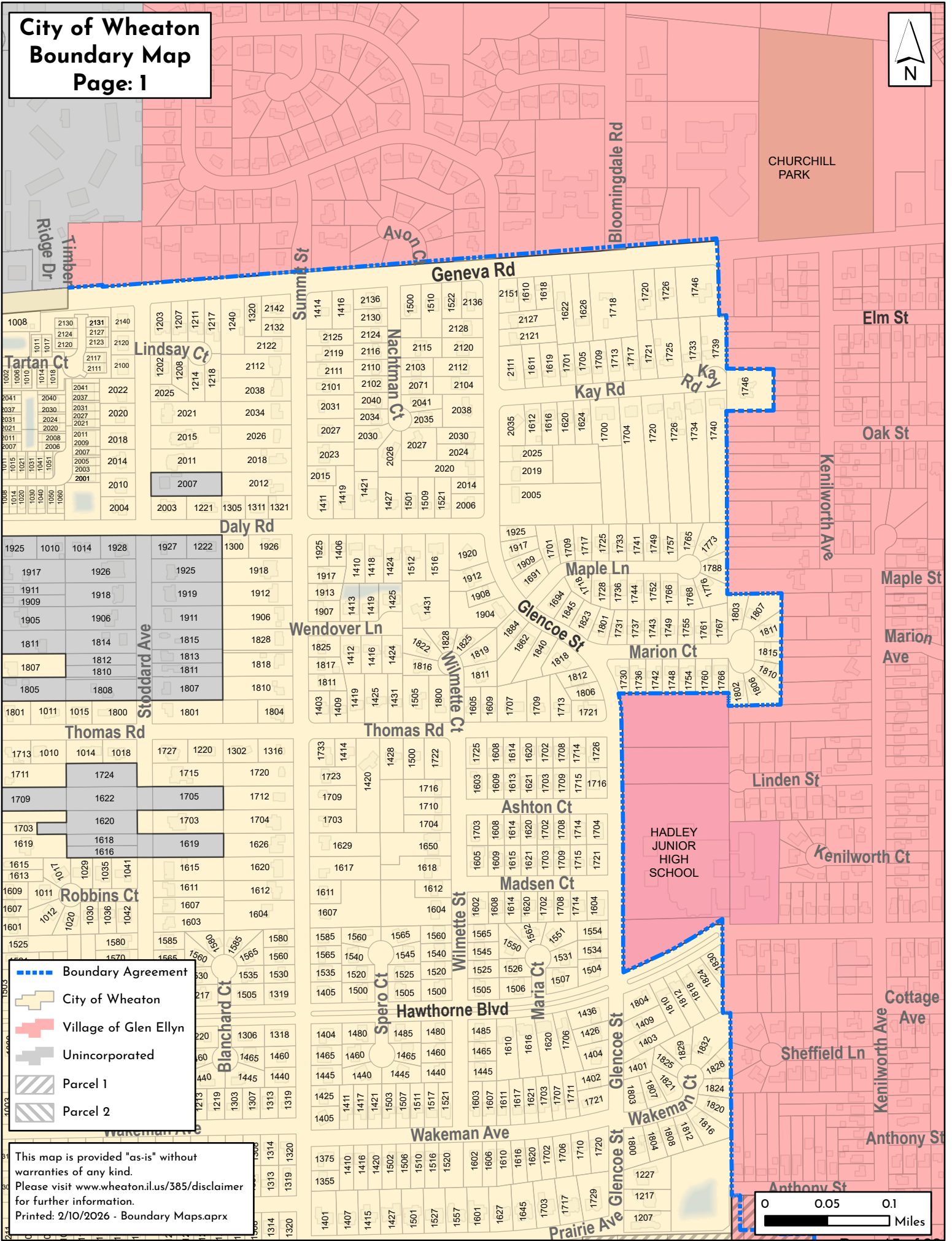

Legend

- - - - Boundary Agreement
- City of Wheaton
- Village of Glen Ellyn
- Unincorporated
- Parcel 1
- Parcel 2

This map is provided "as-is" without warranties of any kind. Please visit www.wheaton.il.us/385/disclaimer for further information. Printed: 2/10/2026 - Boundary Maps.aprx

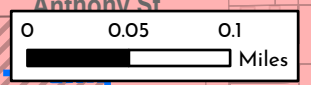

**City of Wheaton
Boundary Map
Page: 3**

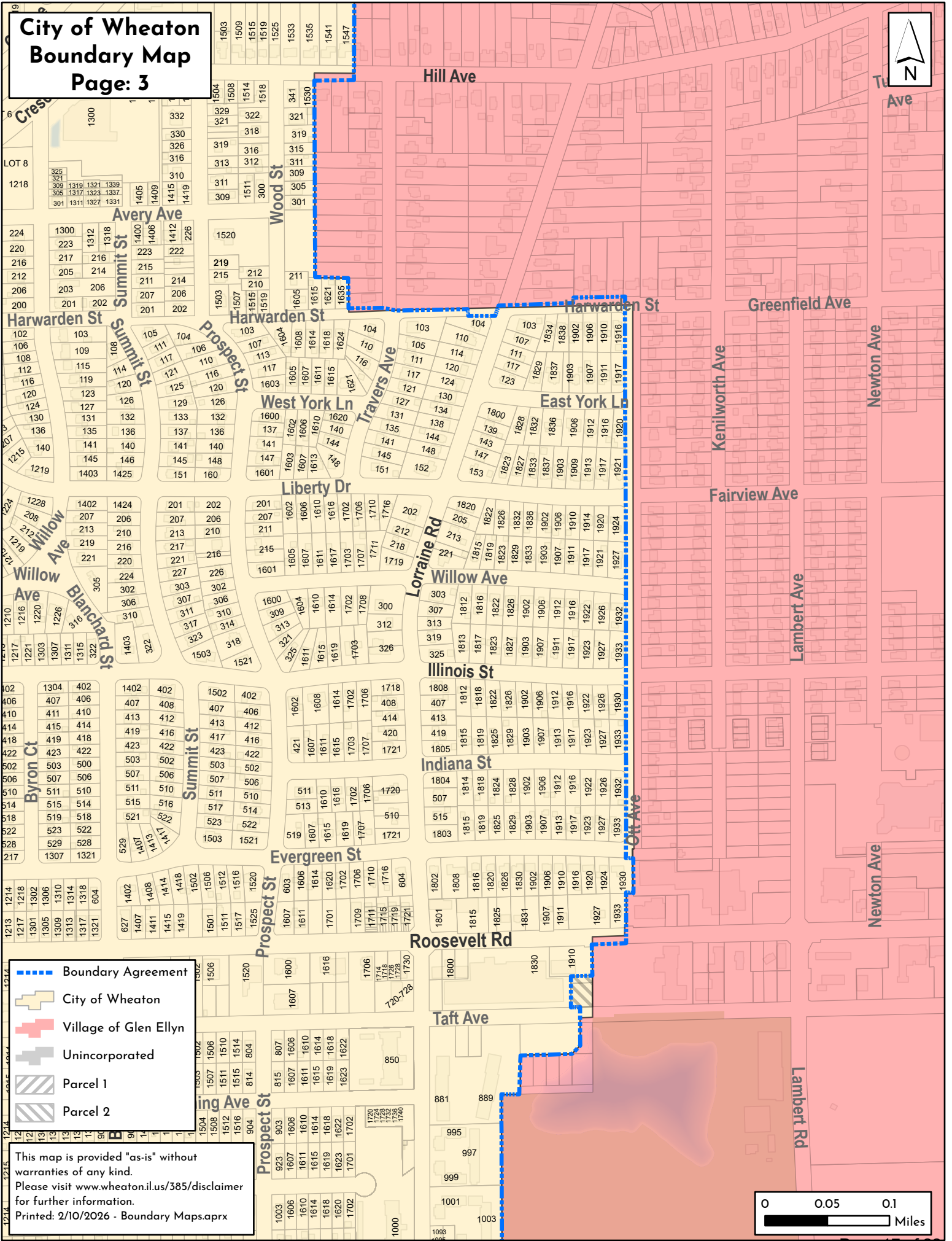

- - - - Boundary Agreement
- City of Wheaton
- Village of Glen Ellyn
- Unincorporated
- Parcel 1
- Parcel 2

This map is provided "as-is" without warranties of any kind.
Please visit www.wheaton.il.us/385/disclaimer for further information.
Printed: 2/10/2026 - Boundary Maps.aprx

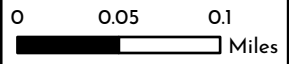

**City of Wheaton
Boundary Map
Page: 4**

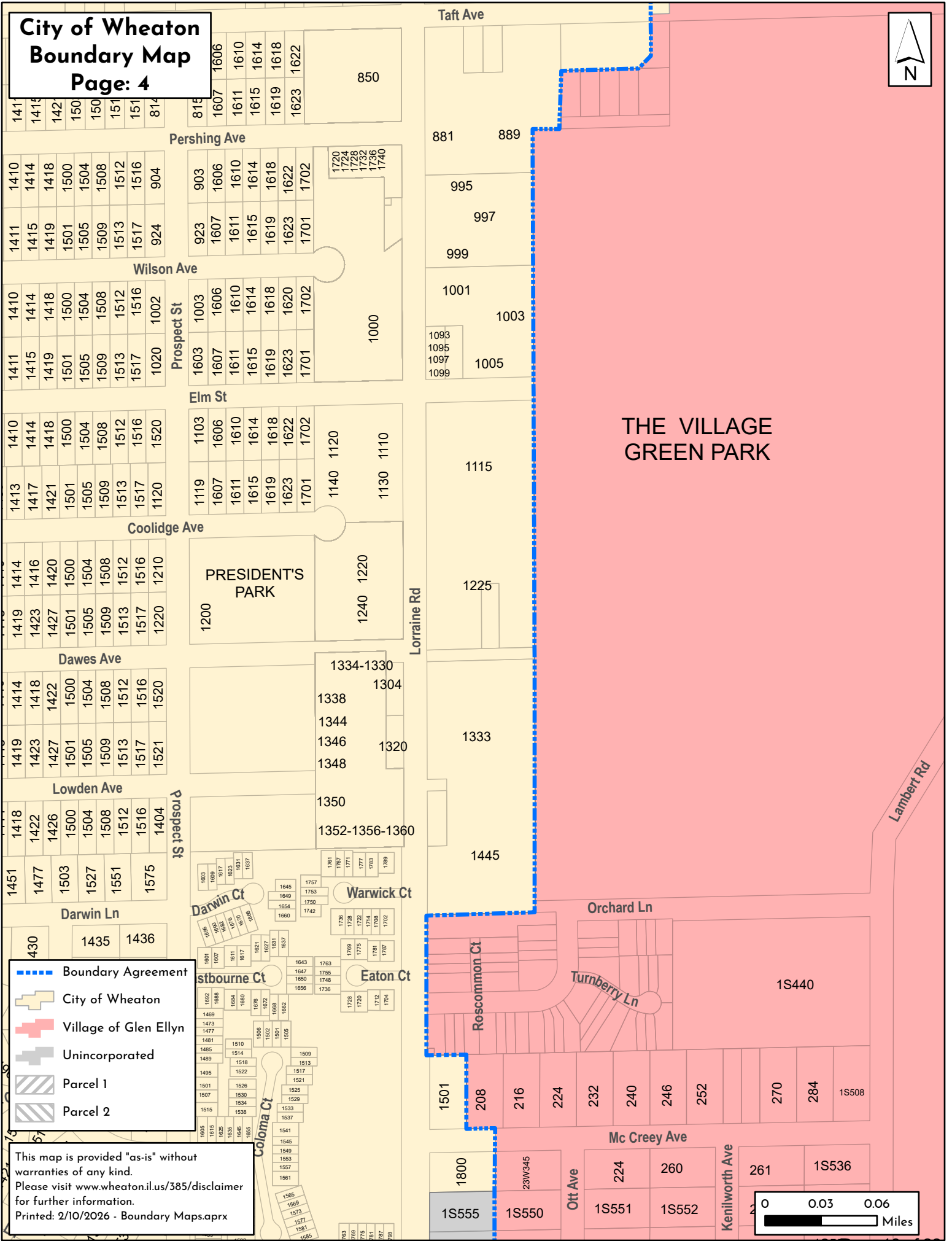

- - - - - Boundary Agreement
- City of Wheaton
- Village of Glen Ellyn
- Unincorporated
- Parcel 1
- Parcel 2

This map is provided "as-is" without warranties of any kind. Please visit www.wheaton.il.us/385/disclaimer for further information. Printed: 2/10/2026 - Boundary Maps.aprx

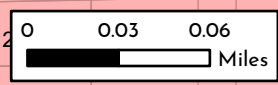

**City of Wheaton
Boundary Map
Page: 5**

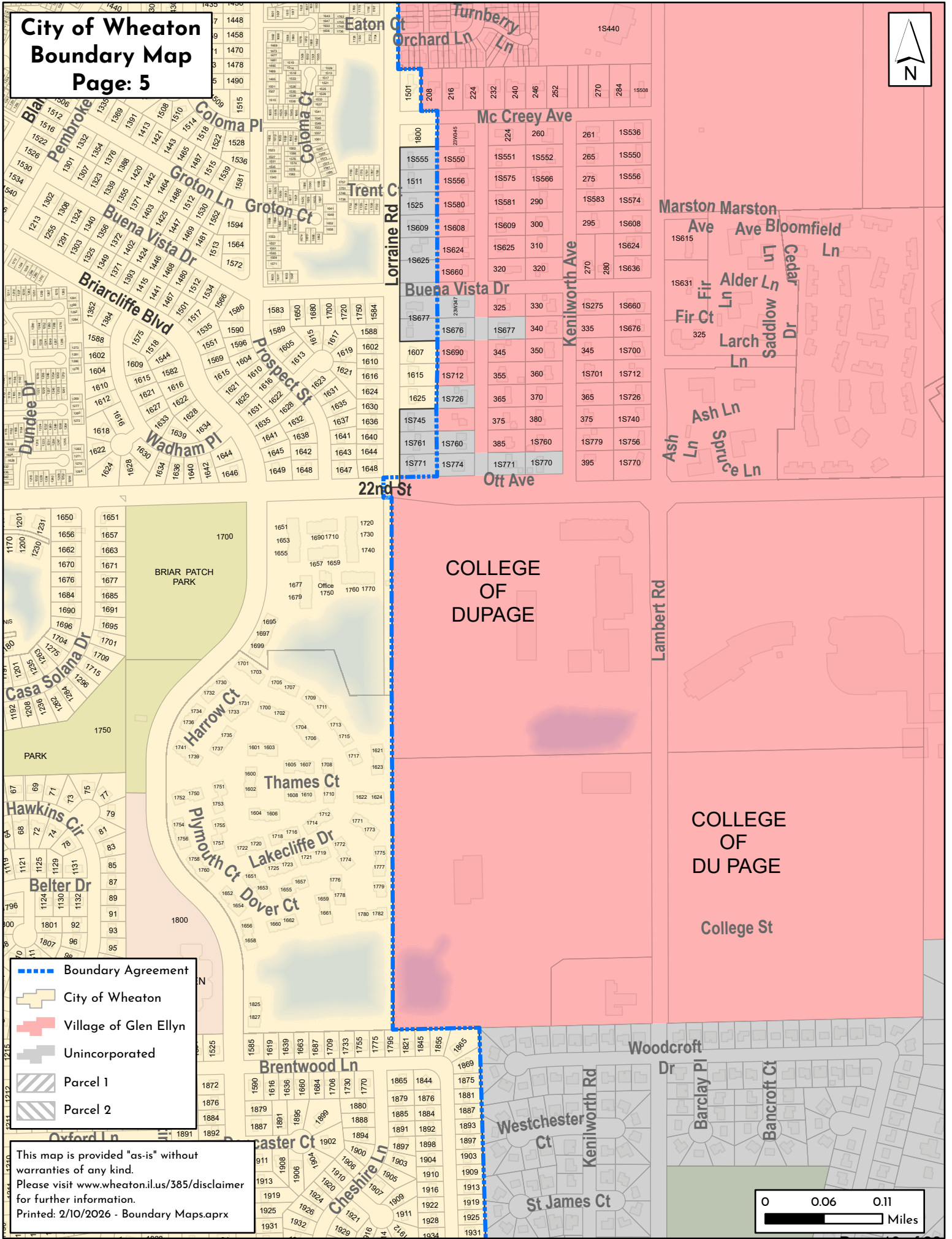

- - - - Boundary Agreement
- City of Wheaton
- Village of Glen Ellyn
- Unincorporated
- Parcel 1
- Parcel 2

This map is provided "as-is" without warranties of any kind. Please visit www.wheaton.il.us/385/disclaimer for further information. Printed: 2/10/2026 - Boundary Maps.aprx

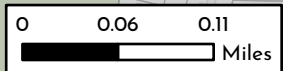

**City of Wheaton
Boundary Map
Page: 6**

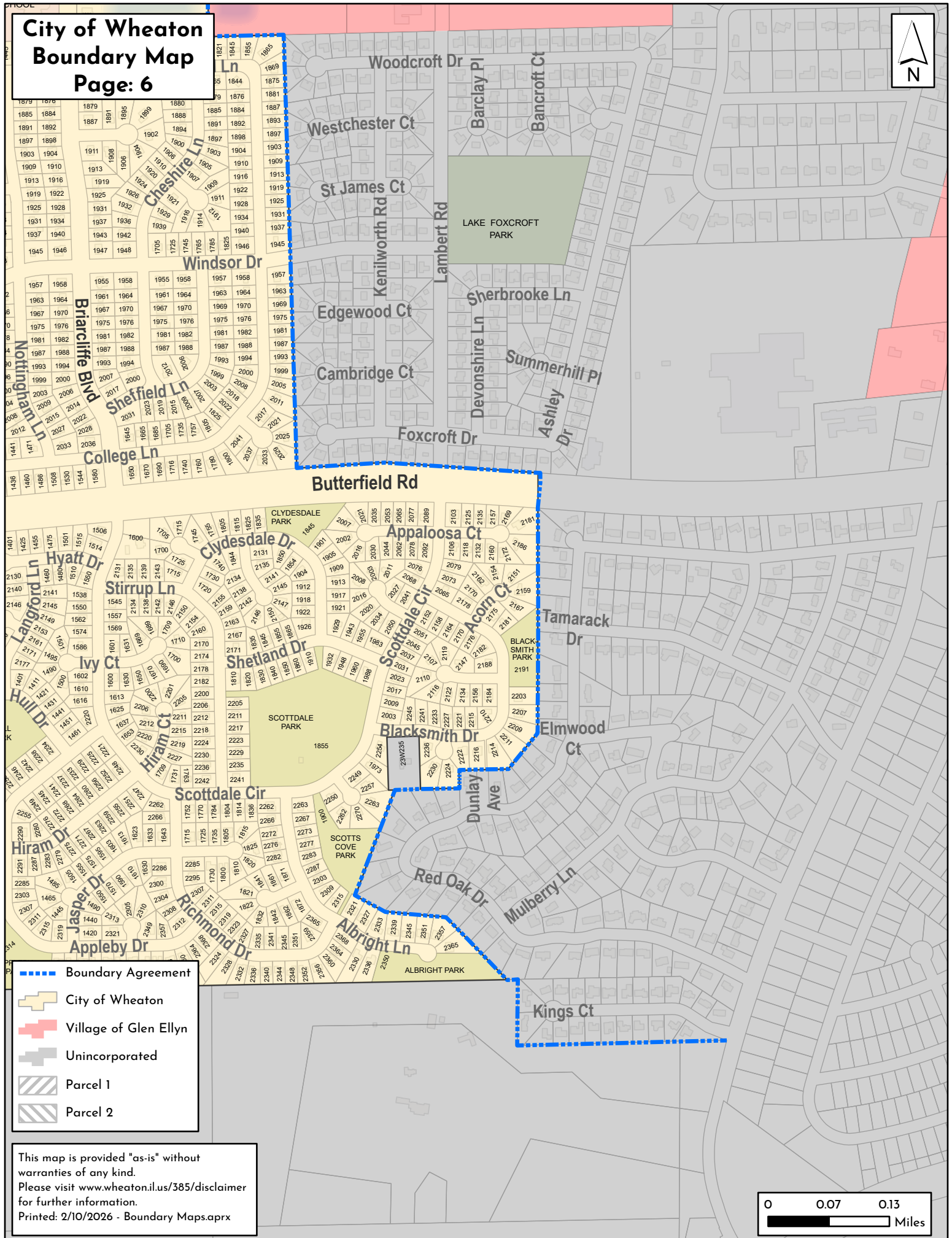

- Boundary Agreement
- City of Wheaton
- Village of Glen Ellyn
- Unincorporated
- Parcel 1
- Parcel 2

This map is provided "as-is" without warranties of any kind.
Please visit www.wheaton.il.us/385/disclaimer for further information.
Printed: 2/10/2026 - Boundary Maps.aprx

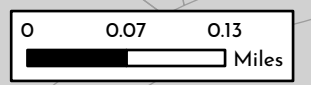

EXHIBIT B
(following page)

Legend





-  Existing FEQ Inundation Area (Anthony Steet Storage)
-  Proposed FEQ Inundation Area (Anthony Street Storage)
-  Proposed 48-inch Storm Sewer
-  Existing 18-inch Storm Sewer

Exhibit B



Sources: Esri, HERE, Garmin, USGS, Intermap, INCREMENT P, NRCan, Esri Japan, METI, Esri China (Hong Kong), Esri Korea, Esri (Thailand), NGCC, (c) OpenStreetMap contributors, and the GIS User Community, Source: Esri, Maxar, Earthstar Geographics, and the GIS User Community

1 inch = 100 feet

N:\spaceco\250175\GIS\Exhibits\Exhibit 2a_Anthony Street Inundation Map.mxd

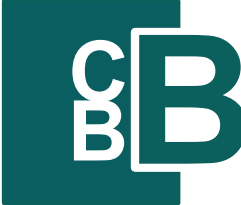

Christopher B. Burke Engineering, Ltd.
 9575 West Higgins Road, Suite 600
 Rosemont, IL 60018
 (847) 823-0500 / FAX (847) 823-0520

	DSGN.		CHKD.	
CLIENT	SPACECO		JOB#	25-0175
TITLE	EXISTING VS PROPOSED CONDITIONS FEQ INUNDATION			DATE 11/04/25
				Exhibit B