



Agenda
Village of Glen Ellyn
Architectural Appearance Commission Meeting
Wednesday, May 14, 2025
7:00 PM
Glen Ellyn Civic Center, Galligan Board Room

Visitors are most welcome to attend all public meetings and can find copies of the Agenda online at www.glenellyn.org prior to the meeting. Any individual with a disability requiring reasonable accommodation in order to participate in a meeting should contact the Village of Glen Ellyn ADA Coordinator, 630-469-5000, at least five (5) business days in advance of the next scheduled meeting.

- A. Call to Order**
- B. Approval of the Minutes**
 - 1) Approval of the March 12, 2025 Architectural Appearance Commission Minutes
- C. Old Business**
- D. New Business**
 - 1) 515 Crescent Blvd. - Exterior Appearance Review for Walk-Up Automated Teller Machine
- E. Chairman's Report**
- F. Trustee Liaison's Report**
- G. Staff Report**

DRAFT MINUTES
Glen Ellyn Architectural Appearance Commission
Wednesday, March 12, 2025 at 7:00 PM
Glen Ellyn Civic Center
Galligan Board Room
535 Duane Street

A. Call to Order and Roll Call

Chairperson Jacobson called the meeting to order at 7:00 PM and explained the Architectural Appearance Commission's function and procedures as an advisory body.

Roll was called.

Present: Chairperson Jacobson and Commissioners Albrecht, Goranov, Mees, Rahn, Schlembach, and Smith

Also in attendance: Anabel Pederson, Associate Planner, Jordan Frahm Associate Planner, Anne Gould Village Trustee, and Adriana Ohl Zamora, Recording Secretary.

B. Approval of the Minutes

Commissioner Albrecht made a motion to approve the draft minutes of the February 12, 2025 meeting. Commissioner Rahn seconded the motion. The motion passed by voice vote.

Commissioner Smith recused herself.

C. Old Business

1. 534 Duane Street, Glen Ellyn IL 60137: Exterior Appearance Review

Staff Presentation

Sworn in, Jordan Frahm, Associate Planner discussed the return of the 534 Duane Street Exterior Appearance Review. The item is returning from the December 11, 2024 meeting due to façade issues that needed to be revised. The petitioner is Ashley Rooney, from Fuchsia Boutique a local clothing store. The façade that was approved in December was shown, as well as the current issues with found structural beams. The revised elevation showed differences in pattern of siding and major difference with the arrangement of the windows. There were also changes in the doors, with one door to one side instead of two in the center. Review of materials and paints were shown. None of the colors had changed from the previous design. Relevant architecture appearance elements fit in with adjacent buildings.

Sworn In, Matt Rooney, Petitioner stated that the color scheme will remain the same, and they are now asking for gas lantern lighting on the façade. Pictures were shown to the Commission. That is the only other change with regards to materials.

Questions and Comments:

Commissioner Albrecht asked why the petitioner chose to have upper and lower changes in window, including removing the transoms from the design. She also asked if there was any consideration continue to highlight the door by keeping the vertical siding and noted that it might capture high visual impact of the previous design.

Petitioner Matt Rooney responded that the original doors were 9ft tall and the steel beam they found is limiting the height to door to 8ft, above beam there are open truces that frame the roof. They can no longer have transoms or the height to accommodate for the windows. Mr. Rooney did note that they could consider changing the siding design.

Chairperson Jacobson stated that it was more effective when the door was centered; she thinks the newer design works well but the petitioner could look at the option with the off-centered door.

Commissioner Goranov stated that the easiest option would be to have vertical siding on either side of the door. He asked if the petitioner had considered having a blackened transom just above the door.

Mr. Rooney stated that he had not considered it but that is an option, however he reiterated that the design it is off center which may contribute to the final look.

Commissioner Goranov stated that he believes it is better to be off centered, and the building would have the sign to balance the elevation.

Commissioner Albrecht stated that she liked the look of the new light fixtures.

Commission Recommendation

Chairperson Jacobson made the motion:

After conducting a public meeting and deliberating on the request of the petitioner The Village of Glen Ellyn for approval of an exterior appearance review for 534 Duane St., Glen Ellyn in the C5B Zoning District, the Architectural Appearance Commission hereby recommends approval based on the findings of fact, as discussed or amended at the Architectural Appearance Commission public meeting on March 12, 2025, which are hereby incorporated into the Motion by reference as fully set forth herein, and a copy of which will be attached to the minutes of this meeting and kept on file as part of the permanent records of the Village. The Architectural Appearance Commission makes this recommendation of approval with the following conditions:

1. That the project be constructed in substantial conformance with the plans and testimony presented at the Architectural Appearance Commission public meeting and before the Village Board of Trustees.
2. That the Petitioner consider the architectural appearance around main entrance to more reflect original design
3. That the new gas light fixture replaces the previously approved light fixture.

Commissioner Schlembach seconded the motion. The motion passed roll call with all commissioners present voting “Yes”.

Commissioner Smith rejoined the meeting.

D. New Business

None

E. Chairman’s Report

Chairperson Jacobson mentioned a comment from a resident concerned with the new train station and the removal of trees. Associate Planner Pederson noted that those comments can be passed onto staff.

F. Trustee Liaison Report

Trustee Gould discussed updates with regards to the following:

1. The Downtown Event Park got approved for rezoning and special use events, contractual completion date is end of December 2026 to be completed in 2 phases.
2. There were two workshops on motorized bikes and electric scooters. There have been some complaints of people using them on sidewalks at high speeds. The police department is looking into what other villages are doing and may choose to focus on an education campaign downtown.
3. Permit fees have been approved and will go into effect when the Village converts to the new community development software system in April.

Anabel Pederson, Associate Planner added that the Village is holding off on releasing the new fees to avoid any confusion. That information should be available next month when staff training and implementation has been completed.

Trustee Gould stated that the Board aiming for a 4% increase in permit fees as they have not been raised in a few years.

Commissioner Goranov asked if the new software system will utilize AI and added that a 4% increase seems reasonable.

Associate Planner Pederson responded that the software is not integrating AI, it functions similar to the permitting software the Village is already using but making things more streamlined by adding a resident portal and improving communication.

G. Staff Report

Anabel Pederson, Associate Planner presented to the Commission the following updates:

1. As noted by Trustee Gould, the Downtown Event Park got approved by the Village Board on March 10, 2025.
2. 580 Duane St. is being held for exterior due to structural issues with the column supports and the owners are communicating with the building department.

Commissioner Schlembach asked about the status of the cost report on the Metra Train Station Project.

Associate Planner Pederson noted that Rich Daubert, Village Engineer has not provided the cost report but he will be contacted for a reminder.

I. Adjournment

Member Albrecht made a motion to adjourn the meeting. Member Goranov seconded the motion and the motion passed by voice vote at 7:25pm.

Respectfully submitted,

Adriana Ohl-Zamora
Recording Secretary



Glen Ellyn
535 Duane Street
Glen Ellyn, IL
60137

Meeting 5/14/2025 7:00 PM
Department: Community Development
Department Head: Jennifer Henaghan
Category: Commission Recommendation
Prepared By: Anabel Pederson

AGENDA ITEM
(ID # 2025-394)

DOC ID: 2025-394

515 Crescent Blvd. - Exterior Appearance Review for Walk-Up Automated Teller Machine

Statement of the Issue:

The petitioner is requesting review and recommendation from the Architectural Appearance Commission regarding the proposed exterior facade alteration of the property known as 515 Crescent Boulevard. The proposed alteration includes the appearance of a walk-up ATM.

Analysis:

BACKGROUND:

On January 13, 2025, the Village Board adopted Ordinance No. 7160, An Ordinance Denying an Exterior Appearance Application for a Proposed Walk-Up Automated Teller Machine at the Property Located at 515 Crescent Boulevard, Glen Ellyn, IL 60137 based on the Architectural Appearance Commission's 5-0 vote to recommend denial. Discussion of the 2024 ATM proposal can be found [here](#).

CURRENT PROPOSAL:

The applicant is proposing an alteration to the exterior appearance of the property located at 515 Crescent Boulevard. The project includes the removal of an existing window and construction of a walk-up ATM with a matching altered window and brick infill. The proposed design was chosen to match the existing building articulation and provide pedestrians with access to banking services through the installation of the new ATM.

1. **Building:** The building is located downtown in the C5A Commercial Zoning District and is a contributing building within the Historic District. The building occupies approximately 5,227.22 square feet and is currently occupied by a real estate agency granted by a Special Use Permit in February of 2022. The current weathered red brick building has colonial style features including white wall paneling at the entrance, and decorative trim along the walls and surrounding the white frame windows.
2. **Design:** The design includes the installation of an NCR SelfServ Walk-Up ATM replacing the most western window of the building's north face. The surrounding area around the proposed ATM will have a window panel on either side, with the space above and below the unit in-filled to match the existing weathered red brick of the existing building. The design

would also include a black fabric awning to be set over the ATM for weather protection of customers.

3. Lighting. The proposed lighting changes includes a new wall sconce for security lighting above the ATM. The sconce is a Cooper Lighting Solution Entri LED measuring 15-3/4" x 7-3/4" x 8-1/8" with a round curved face. It has aluminum housing in a black finish and is proposed to be downlit with a color temperature of 3000K.
4. Proposed Use: The proposed use of an automatic teller machine that is not located on the same property as a bank or financial institution is currently not permitted in the Village Zoning Code. The use will be subject to a proposed Text Amendment and Special Use Permit application to be considered by the Plan Commission before final consideration by the Village Board of Trustees. Village Staff is bringing the item forward to the AAC for an exterior appearance review as an appropriate first action for this application as the proposed use would significantly alter the façade of a contributing building within the C5A Zoning District. The project will also appear before the Historic Preservation Commission for consideration of the impact on the historical character of the downtown. The AAC will be commenting on the exterior appearance only, and will not make recommendations on the proposed use of the ATM.

ARCHITECTURAL APPEARANCE GUIDELINES:

3.11 Expansion, additions, and remodeling of existing structures should emphasize compatibility with the original structure in terms of roof structure, materials, openings, and detailing.

Staff does not believe that the proposed alterations conform to this guideline.

Budget Impact:

Contribution to Strategic Plan

Action Requested:

The Architectural Appearance Commission is being asked to consider the petitioner's request for exterior appearance and make a recommendation to the Village Board for approval, approval with conditions, or denial. In reviewing the request, the Commission should consider how the proposed exterior appearance conforms to the Appearance Review Guidelines. In reviewing the project, the AAC may wish to inquire about/encourage the petitioner to:

1. Utilize design elements to create an alteration that is in harmony with the surrounding buildings.
2. Consider the proposed alteration in the context of the larger downtown area.
3. Incorporate Architectural Appearance Guidelines into feedback and review comments.

Attachments:

1. Aerial Map
2. Zoning Map
3. Plat of Survey
4. Site Plan and Planning Set

5. Floor Plan
6. NCR SelfServ ATM64 Brochure
7. NCR 2064 General Info Spec Sheet
8. Materials - Bricks and Awning
9. Lighting - Wall Sconce Specs
10. Rejected Alcove Design

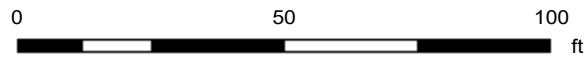
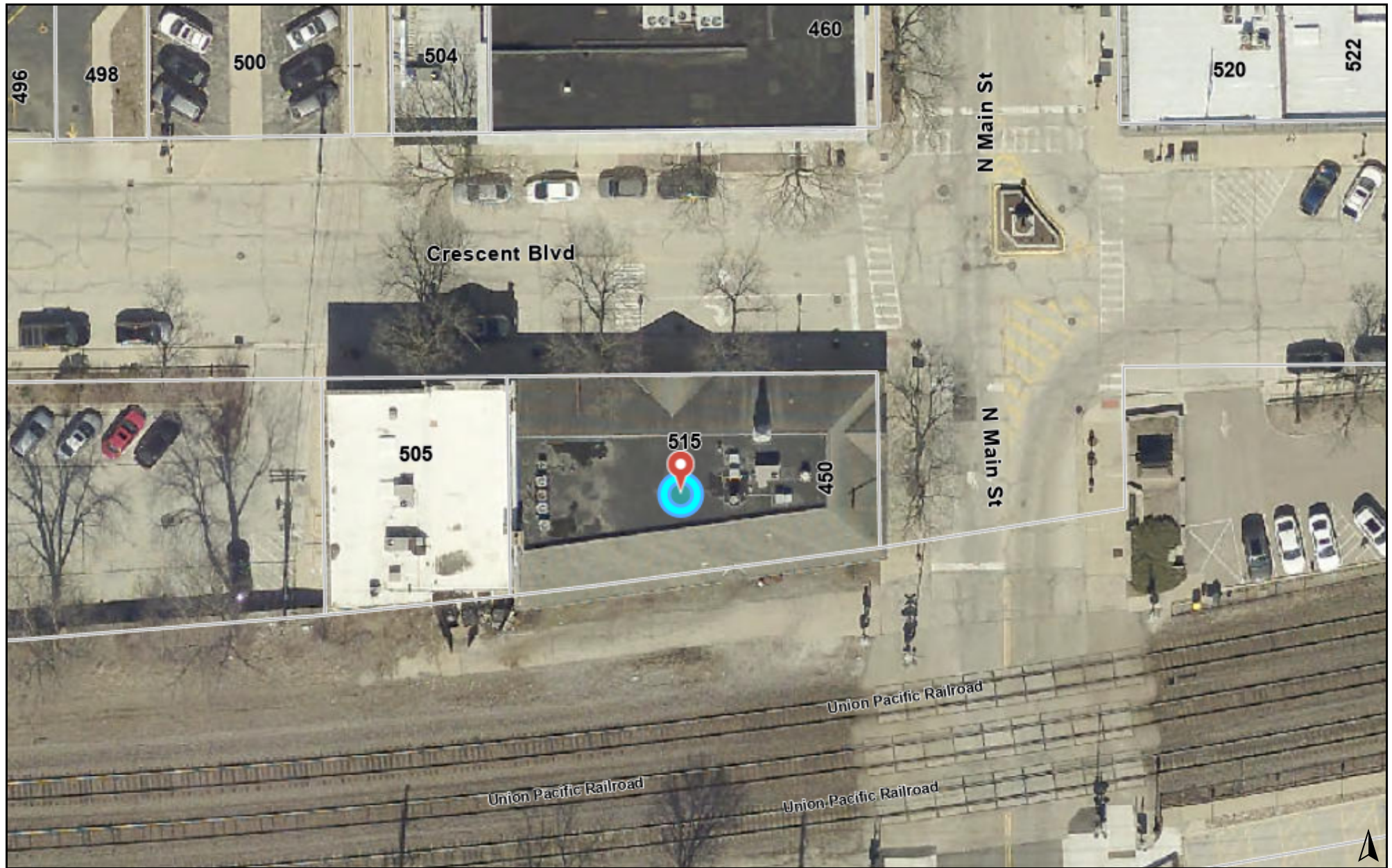

Print Date: 8/27/2024

Notes

Disclaimer: The GIS Consortium and MGP Inc. are not liable for any use, misuse, modification or disclosure of any map provided under applicable law. This map is for general information purposes only. Although the information is believed to be generally accurate, errors may exist and the user should independently confirm for accuracy. The map does not constitute a regulatory determination and is not a base for engineering design. A Registered Land Surveyor should be consulted to determine precise location boundaries on the ground.

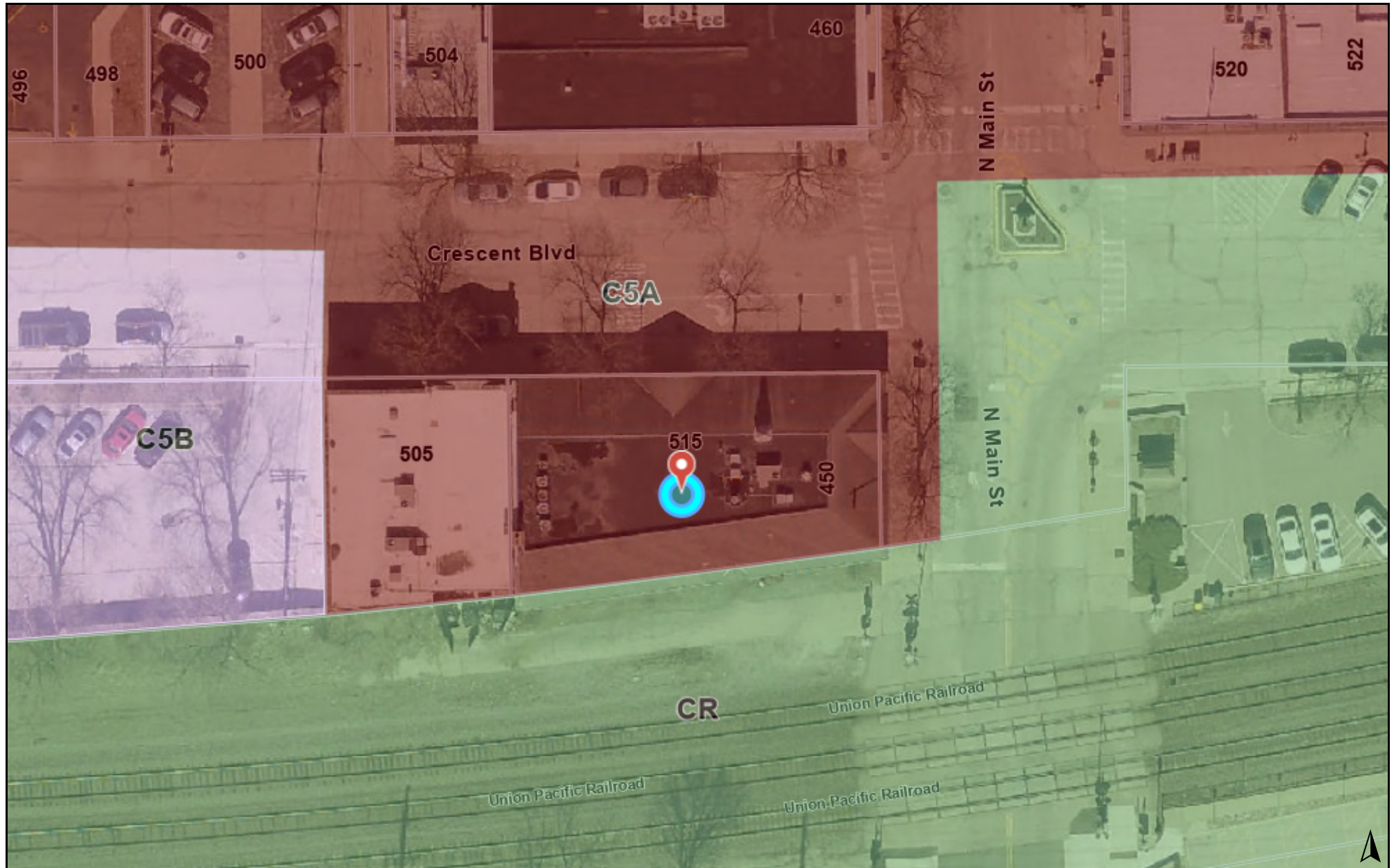

Print Date: 8/27/2024

Notes

Disclaimer: The GIS Consortium and MGP Inc. are not liable for any use, misuse, modification or disclosure of any map provided under applicable law. This map is for general information purposes only. Although the information is believed to be generally accurate, errors may exist and the user should independently confirm for accuracy. The map does not constitute a regulatory determination and is not a base for engineering design. A Registered Land Surveyor should be consulted to determine precise location boundaries on the ground.

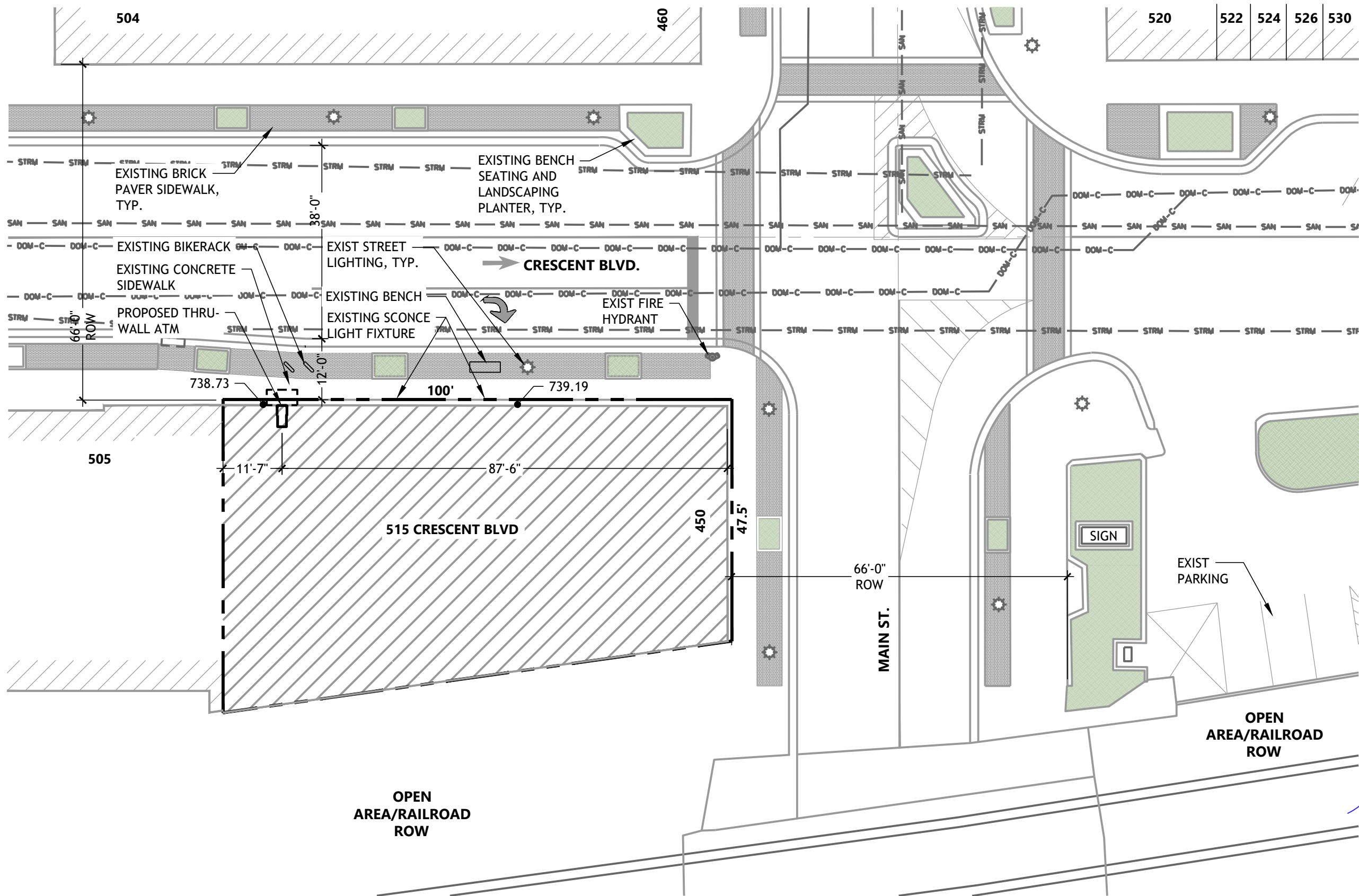

LEGEND

-  BRICK PAVERS
-  LANDSCAPING
-  FIRE HYDRANT
-  STREET LIGHT
-  SANITARY SEWER LINE
-  STORM SEWER LINE
-  DOMESTIC WATER LINE

EXISTING GRADES ARE PER CITY STREET IMPROVEMENT DRAWINGS.

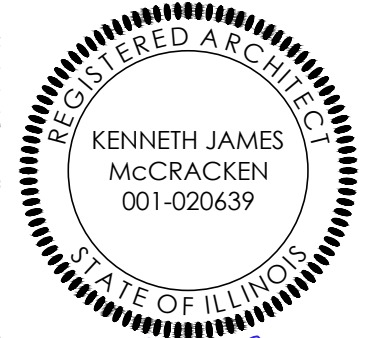

[Signature]
 04/17/25
 EXPIRES: 11/30/26
 01470

SCALE: 1" = 20'-0"
 DRWN BY: VR
 DATE: 4/17/2025









**US BANK WALL MOUNTED ATM
 515 CRESCENT BLVD
 SITE PLAN**





LEGEND

-  ZONING: CR
-  ZONING: C5A
-  ZONING: C5B
-  BUILDING IN NORTH HISTORIC DISTRICT PER CITY OF GLEN ELLYN HISTORICAL DISTRICTS MAP
-  SUBJECT PROPERTY
-  PAVED ROADS



VR
04/17/25
EXPIRES: 11/30/26 01470

DRWN BY: VR
DATE: 4/17/2025

NOT TO SCALE



**US BANK WALL MOUNTED ATM
515 CRESCENT BLVD
SITE MAP**



2

EXISTING ASPHALT SHINGLES

EXISTING WALL LIGHT FIXTURES, TYP., LUMENS UNKNOWN, MAINTENANCE BY OTHERS



EXISTING STREET LAMP, LUMENS UNKNOWN, MAINTENANCE BY OTHERS

EXISTING RED BRICK WALL FINISH

EXISTING WHITE WOOD PANELING

EXISTING CUSTOM WOOD ASSEMBLY WINDOW UNITS. TYP.

EXTERIOR ELEVATION - EXISTING



OPTION: VILLAGE AAC TO DETERMINE IF CANOPIES PROVIDED AT ADJACENT WINDOWS, TO MATCH.

PROPOSED NEW FABRIC CANOPY (BLACK) AT ATM WITH SQUARE BOXED VALANCE

PROPOSED CUSTOM WOOD ASSEMBLY WINDOW UNITS, TO MATCH EXISTING ADJACENT WINDOW ASSEMBLIES

PROPOSED THROUGH WALL NCR SELFSEV 64 ATM KIOSK. PROVIDE STANDARD TRIM FACE AT INSERT

PROVIDE BRICK IN-FILL TO MATCH EXISTING BUILDING

EXTERIOR ELEVATION - PROPOSED



04/17/25
EXPIRES: 11/30/26

01470

DRWN BY: VR
DATE: 4/17/2025



US BANK WALL MOUNTED ATM
515 CRESCENT BLVD
EXTERIOR ELEVATION

3



VIEW FROM ACROSS CRESCENT BLVD



VIEW FROM MAIN STREET SIDE OF BUILDING



VIEW FROM ACROSS CRESCENT BLVD



VIEW FROM ACROSS CRESCENT BLVD



Kenneth James McCracken
 04/17/25
 EXPIRES: 11/30/26 01470

DRWN BY: VR
 DATE: 4/17/2025



US BANK WALL MOUNTED ATM
 515 CRESCENT BLVD
 EXISTING STREET PHOTOS

4

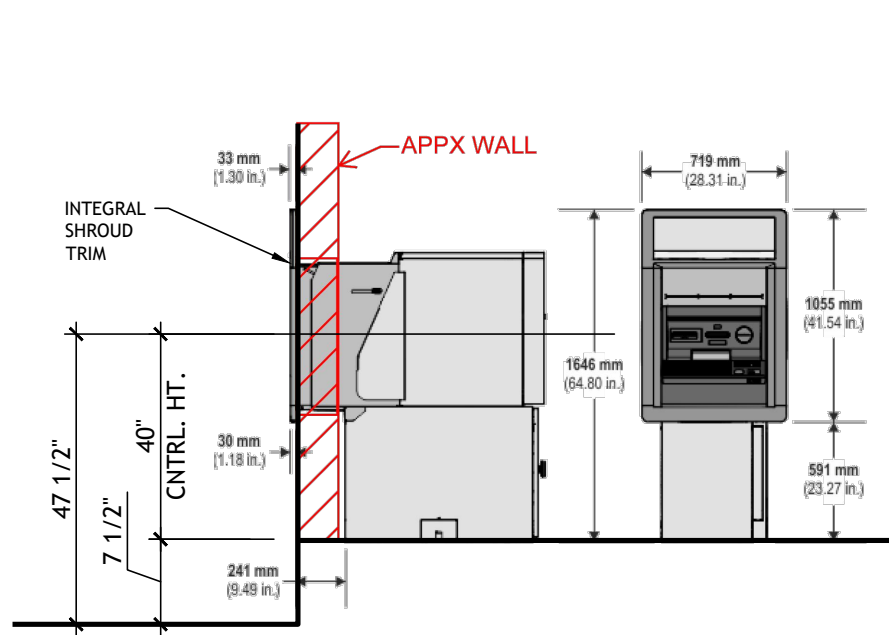

3 - ATM DETAIL
N.T.S.

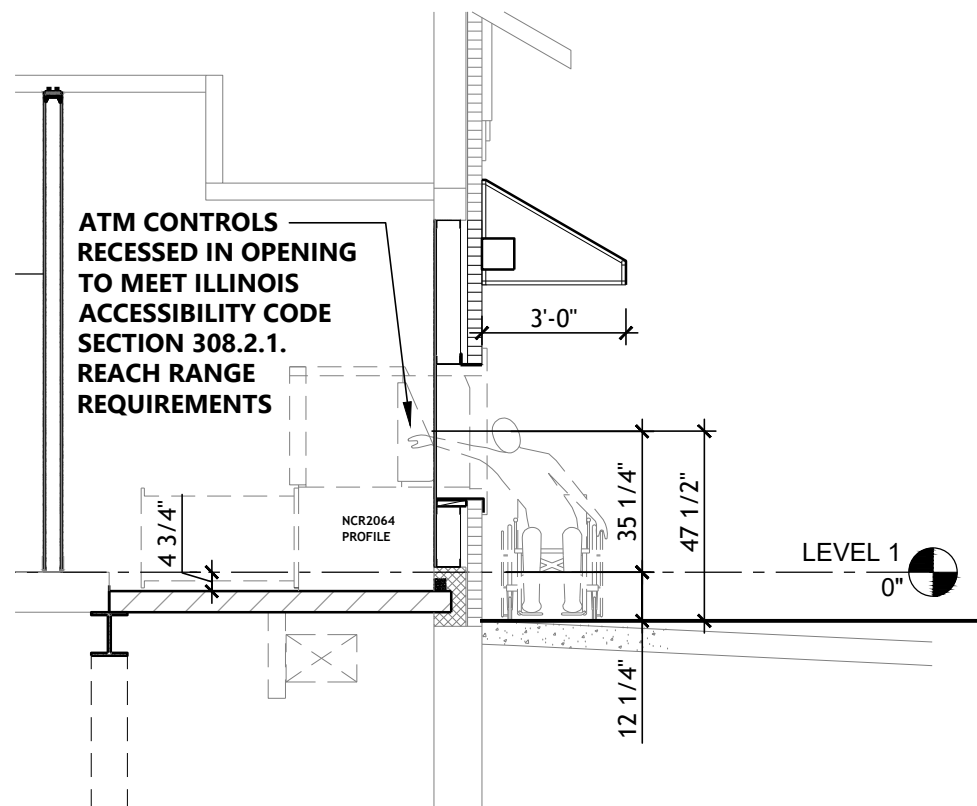

2 - ATM/WALL SECTION - PROPOSED
SCALE: 1/4" = 1'-0"

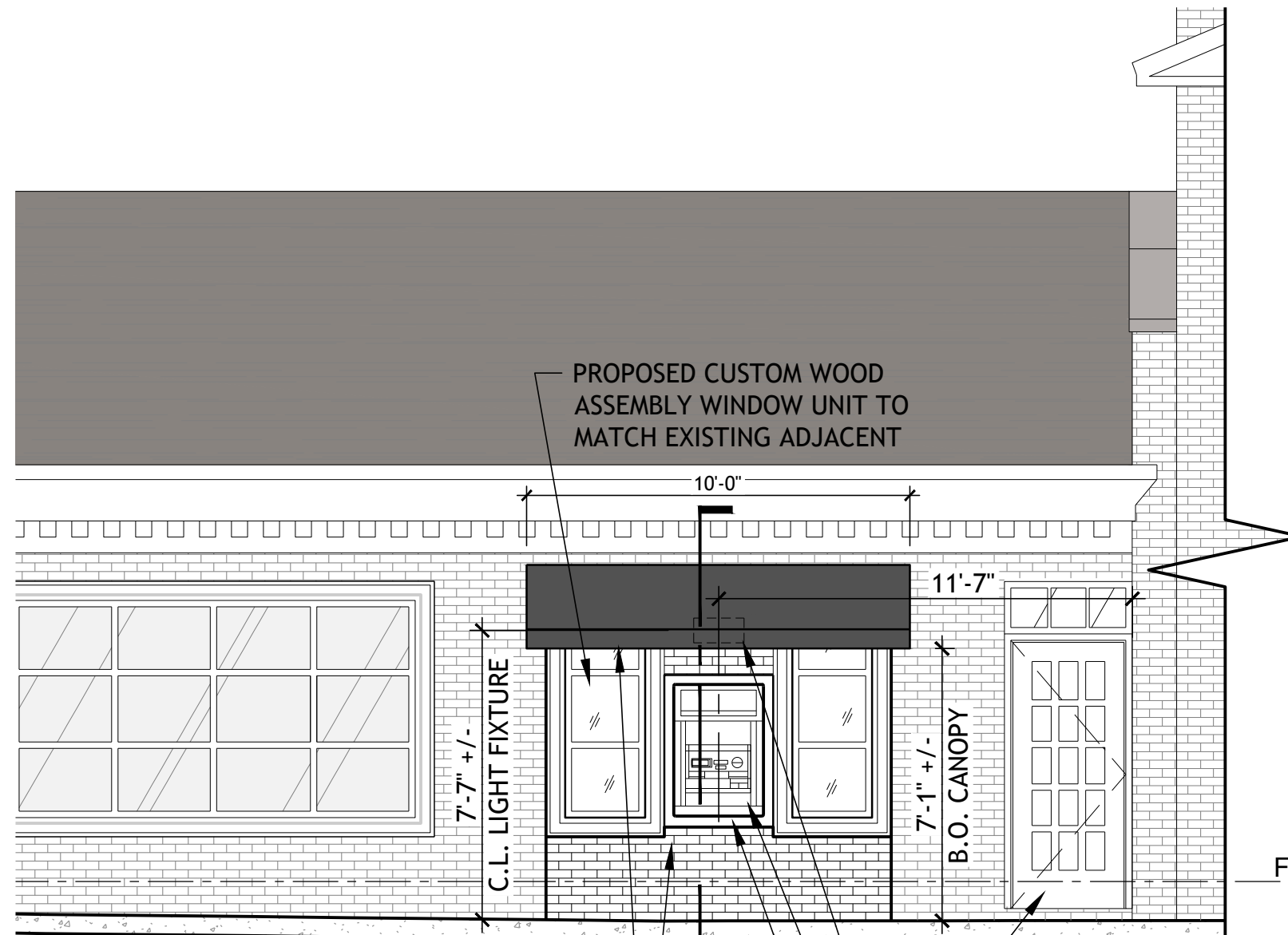

TRADITIONAL FABRIC AWNING, BLACK, WITH SQUARE BOXED VALANCE, TO MATCH ADJACENT PROPERTY

BRICK IN-FILL TO MATCH EXISTING BUILDING; METROBRICK FAST SHIP BLEND 7 OR SIMILAR, MASON TO VERIFY MATERIAL MATCH, AND PROVIDE SUBMITTAL TO ARCHITECT FOR APPROVAL FOR ALTERNATE(S) AS REQUIRED

1 - EXTERIOR ELEVATION - PROPOSED
SCALE: 1/4" = 1'-0"

FINISH FLOOR 0"

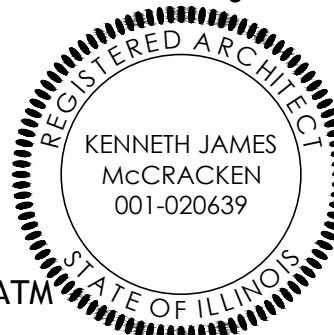

04/17/25
EXPIRES: 11/30/26 01470

DRWN BY: VR
DATE: 4/17/2025



US BANK WALL MOUNTED ATM
515 CRESCENT BLVD
DETAILS



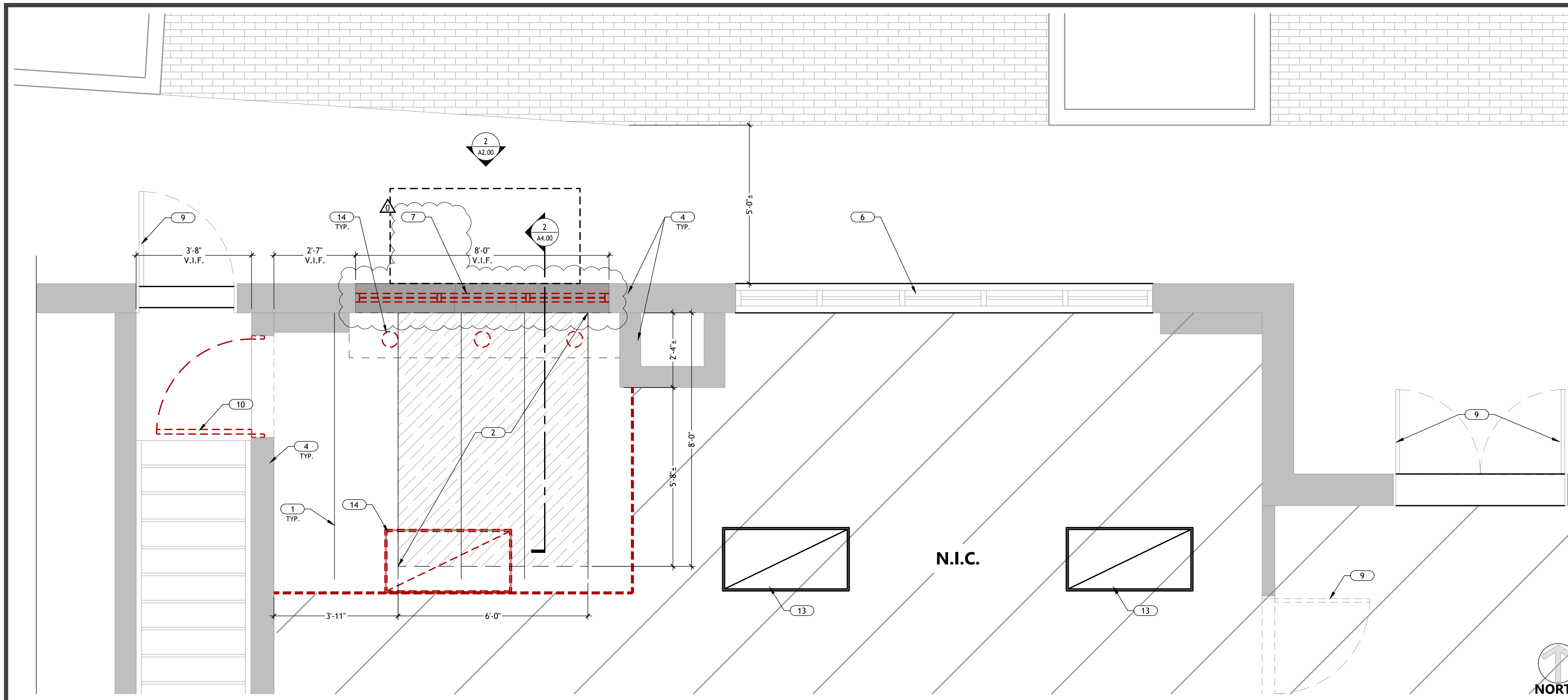

ENLARGED PLAN - DEMOLITION

1/2" = 1'-0" 2

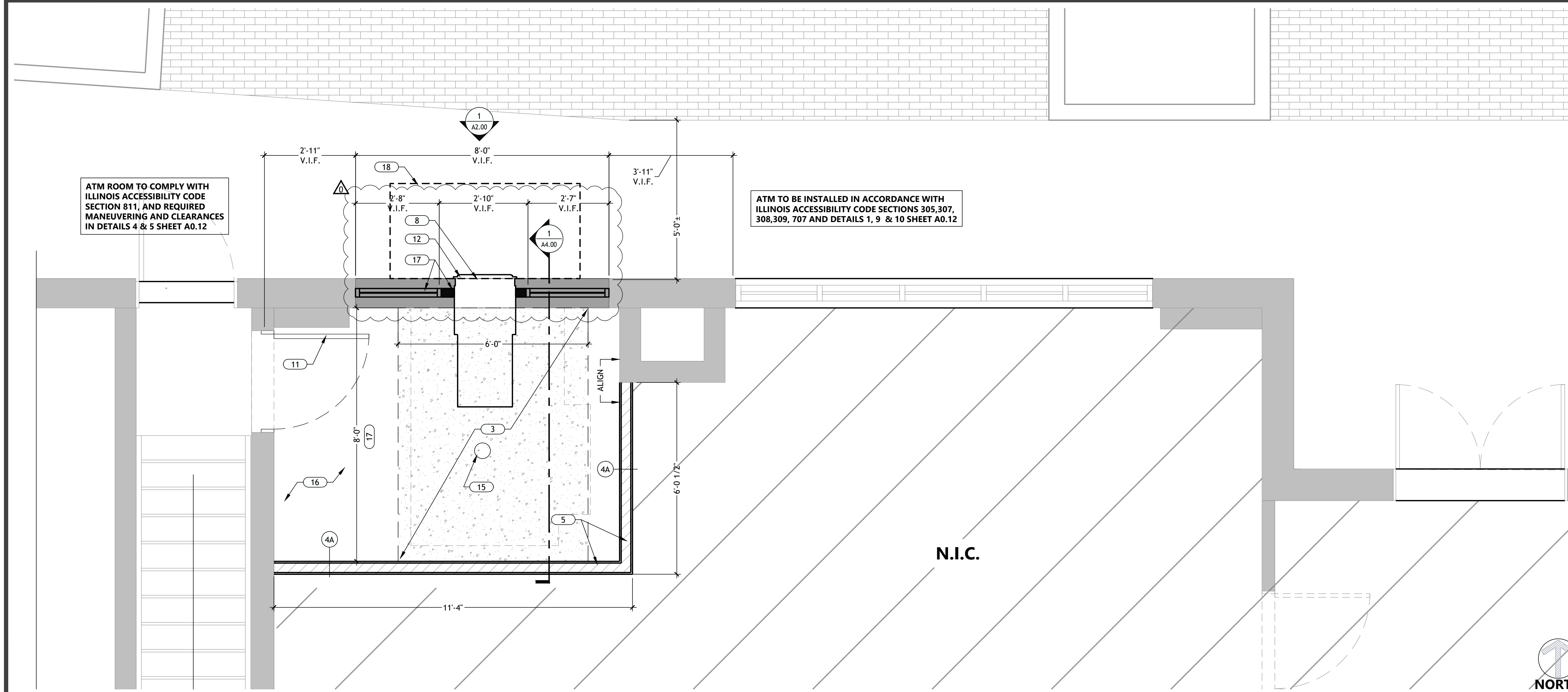

ENLARGED PLAN - PROPOSED

1/2" = 1'-0" 1

- ### GENERAL NOTES
- REFER TO A0.00 FOR SCOPE OF WORK, ABBREVIATIONS AND SYMBOL LEGEND
 - CONTRACTOR SHALL COORDINATE SUITE/SITE ACCESS WITH CLIENT CONSTRUCTION MANAGER.
 - ALL DEMOLITION AND CONSTRUCTION SHALL BE CONDUCTED DURING BUSINESS HOURS, ACCORDING TO NOISE ORDINANCE OF AHJ.
 - CONTRACTOR SHALL VISIT THE SITE AND BECOME GENERALLY FAMILIAR WITH THE EXISTING CONDITIONS PRIOR TO COMMENCING THE WORK.
 - CONTRACTOR SHALL NOTIFY THE OWNER OF ANY AND ALL DISCREPANCIES BETWEEN THE DRAWINGS AND EXISTING CONDITIONS, PRIOR TO PROCEEDING WITH WORK.
 - CONTRACTOR SHALL PROVIDE PROTECTION AGAINST MOISTURE, IMPACT AND/OR DAMAGE AT ALL SURFACES AND OPENINGS AFFECTED BY DEMOLITION AND CONSTRUCTION OF PROPOSED PROJECT. CONTRACTOR SHALL BE RESPONSIBLE TO PATCH AND REPAIR ANY DAMAGED AREAS, AT NO ADDITIONAL COST TO THE OWNER.
 - CONTRACTOR TO CONFIRM EXISTING SMOKE DETECTOR AND FIRE ALARM SYSTEM(S) ARE OPERATIONAL AND FUNCTION PROPERLY. CONTRACTOR SHALL NOTIFY CONSTRUCTION MANAGER FOR ANY REQUIRED REPAIR.
 - ALL DIMENSIONS ARE TO FINISH FACE OF PARTITION AND/OR CENTERLINE OF COLUMN GRIDLINE.
 - ALL INTERIOR DOORS ARE TO BE LOCATED 4" FROM ADJACENT PARTITION CORNER, UNO.
 - PROVIDE AND INSTALL FIRE-RESISTANT LAMINATE PLYWOOD BLOCKING IN WALLS FOR MILLWORK, CABINETS, GRAB BARS, FIXTURES, HANDRAILS, RACKS, AND MOUNTED TOILET ACCESSORIES, AS REQ.
 - OBJECTS THAT APPEAR TO BE ALIGNED SHALL BE ALIGNED.
 - TENANT DEMISING WALLS SHALL EXTEND TO UNDERSIDE OF APPLICABLE DECK, REF. A4.01
 - LIGHT DESIGN SHALL COMPLY WITH ILLINOIS DEPARTMENT OF FINANCIAL PROFESSIONAL REGULATION DIVISION OF BANKING REGULATION AUTOMATED TELLER MACHINE SECURITY ACT SECTION 10:
 - THERE SHALL BE A MINIMUM OF 10 CANDELFoot POWER AT THE FACE OF THE AUTOMATED TELLER MACHINE AND EXTENDING OUTWARD 5 FEET.
 - THERE SHALL BE A MINIMUM OF 2 CANDELFoot POWER WITHIN 50 FEET FROM ALL UNOBSTRUCTED DIRECTIONS FROM THE FACE OF THE AUTOMATED TELLER MACHINE. IN THE EVENT THE AUTOMATED TELLER MACHINE IS LOCATED WITHIN 10 FEET OF THE CORNER OF THE BUILDING AND THE AUTOMATED TELLER MACHINE IS GENERALLY ACCESSIBLE FROM THE ADJACENT SIDE, THERE SHALL BE A MINIMUM OF 2 CANDELFoot POWER ALONG THE FIRST 40 UNOBSTRUCTED FEET OF THE ADJACENT SIDE OF THE BUILDING.

- ### KEYNOTES
- | KEYNOTE DESCRIPTION |
|--|
| 1. EXISTING STRUCTURAL PRE-CAST CONCRETE FLOOR PLANK, PROTECT IN PLACE ADJACENT TO CONSTRUCTION AREA(S). |
| 2. EXISTING STRUCTURAL PRE-CAST CONCRETE FLOOR PLANK, SAW-CUT IN PLACE AT LOCATIONS DESIGNATED ON PLAN. CONTRACTOR SHALL SCAN SLAB PRIOR TO ANY MODIFICATIONS. INSTALL NEW STRUCTURAL COLUMNS AND BEAMS PRIOR TO DEMOLITION. REFER TO STRUCTURAL DRAWINGS. |
| 3. NEW STRUCTURAL FLOOR DECK INFILL, PROVIDE COLUMNS AND BEAMS AS DESIGNATED ON STRUCTURAL DRAWINGS. |
| 4. EXISTING WALL TO REMAIN, TYP. UNO. PROTECT FROM HARM, PATCH & REPAIR AS REQUIRED. |
| 5. NEW WALL, REFER TO DETAIL 3/A04.01 FOR WALL TYPE. PROVIDE WALL BASE AND PAINT TO MATCH EXISTING SPACE ON ADJACENT TENANT SIDE. PROVIDE RUBBER BASE AND PAINT ON US BANK TENANT SIDE. |
| 6. EXISTING WINDOW TO REMAIN, PROTECT FROM HARM DURING CONSTRUCTION. |
| 7. REMOVE EXISTING WINDOW, FRAMING AND TRIM IN ITS ENTIRETY; UNIT SHALL BE REMOVED AND RETAINED FOR REUSE, AS APPLICABLE. EXISTING SILL AND LINTEL SHALL REMAIN PROTECTED IN-PLACE DURING REMOVAL OF WINDOW UNIT. |
| 8. MODIFY SILL AT REMOVED WINDOW AS REQ. FOR NEW ATM KIOSK OPENING. PROVIDE SILL PAN AND FLASHING AS REQ. AT MASONRY SAW-CUT(S). |
| 9. EXISTING DOOR TO REMAIN PROTECT FROM HARM DURING CONSTRUCTION. |
| 10. EXISTING DOOR TO BE REMOVED, PATCH AND REPAIR OPENING FOR NEW DOOR. |
| 11. NEW DOOR, VERIFY EXISTING ROUGH OPENING PRIOR TO ORDERING NEW DOOR. |
| 12. NEW ATM KIOSK. |
| 13. EXISTING LIGHT FIXTURE TO REMAIN, PROTECT FROM HARM DURING CONSTRUCTION. |
| 14. REMOVE EXISTING LIGHT FIXTURE, PATCH AND REPAIR CEILING FOR NEW WORK. |
| 15. NEW RECESSED LIGHT FIXTURE, COORDINATE WITH ELECTRICAL DRAWINGS. |
| 16. PATCH AND REPAIR CEILING TO MATCH EXISTING ADJACENT. |
| 17. CUSTOM WOOD FABRICATED WINDOW ASSEMBLY, MATCHING / UTILIZING EXISTING HOLDINGS. |
| 18. TRADITIONAL 6'-0" x 3'-0" FABRIC AWNING, BLACK, WITH SQUARE BOXED VALANCE, TO MATCH ADJACENT PROPERTY. |

LEGEND

KEY	DESCRIPTION
	EXISTING WALLS TO REMAIN
	NEW 1 HOUR RATED INTERIOR PARTITIONS
	NEW EXTERIOR WALL INFILL
	AREA NOT IN CONTRACT
	AREA OF EXISTING FLOOR DECK TO BE REMOVED
	NEW STRUCTURAL CONCRETE FLOOR

1101 CENTRAL EXPRESSWAY S SUITE 100 ALLEN, TX 75013
 PROJECT CONTACT: TRAVIS HALL PHONE: 409.406.4443 FAX: 409.406.4443
 ARCHITECTURE Program Management Permitting KEN McCracken, ARCHITECT INC. DESIGN GROUP, INC.

SEAL: **N.F.C.**

CONSULTANT:

usbank

US BANK
 STORE NO.: N/A
 515 CRESCENT BLVD
 GLEN ELLYN, IL 60137

REV	DATE	DESCRIPTION
△	04.22.2025	PLANNING - AAC SUBMIT
△	04.25.2025	PLANNING - AAC PRESCREEN

DRAWN BY: PJO
 CHECKED BY: TLH

ARCH. PROJECT NO.: **FBC25001.0**

SHEET NAME: **DEMOLITION & PROPOSED PLANS**

SHEET NUMBER: **A1.50**

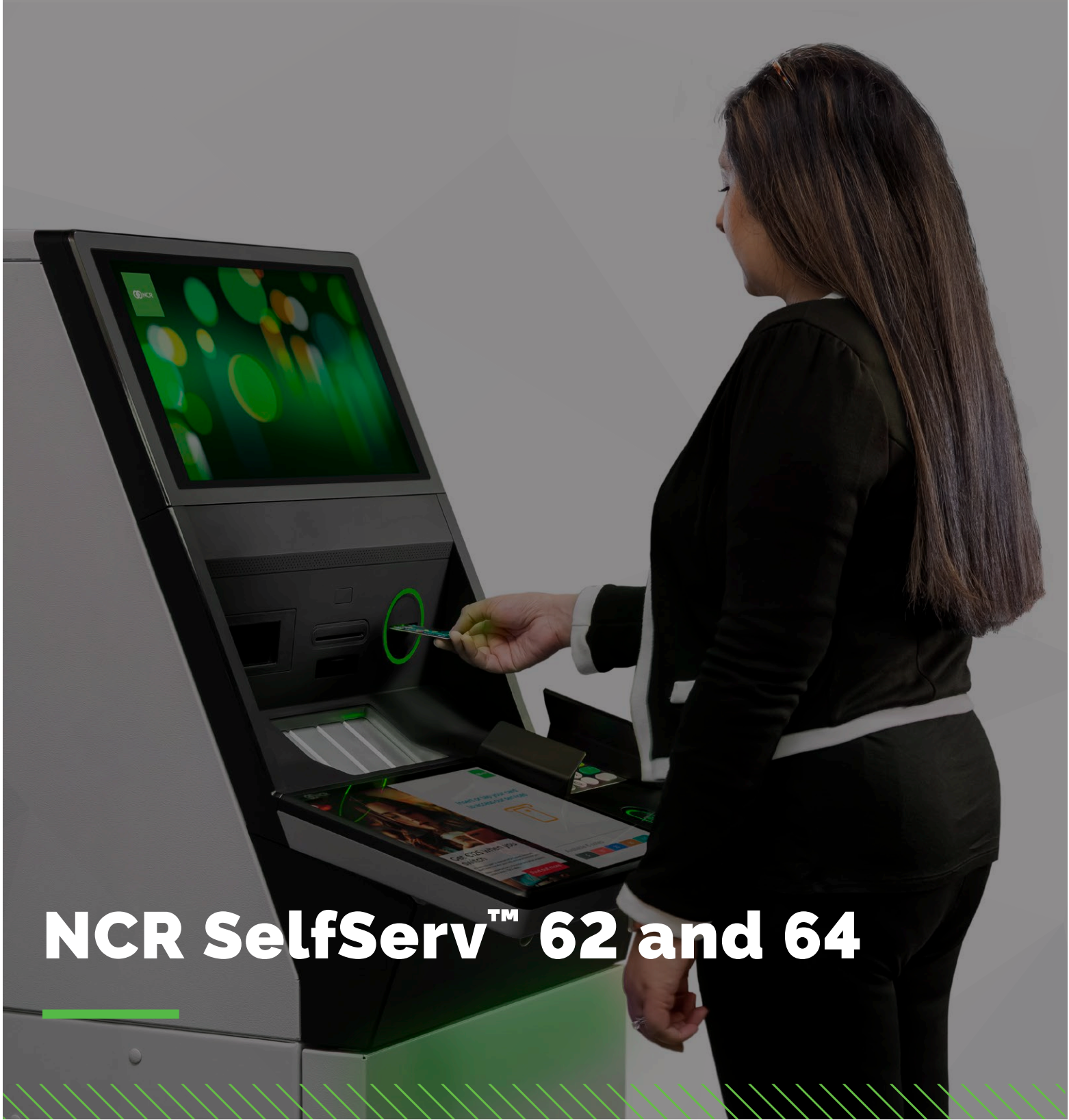

NCR SelfServ™ 62 and 64

A new range of cash recyclers

For more information, visit ncr.com, or email banking.marketing@ncr.com.



NCR SelfServ™ 62

Interior Freestanding Pocket Cash Recycler

Digital first design—15" multi-touch screen and 18.5" dynamic upper panel

Stand out from the crowd—Dynamic marketing & advertising capabilities

Design for service—Enhanced telemetry for fast and easy remote or in field service

Extend presence—Offering full multi-function and ITM* transactions in a compact footprint

Market leading performance—Ensure best in class ATM availability

*available in Phase 2

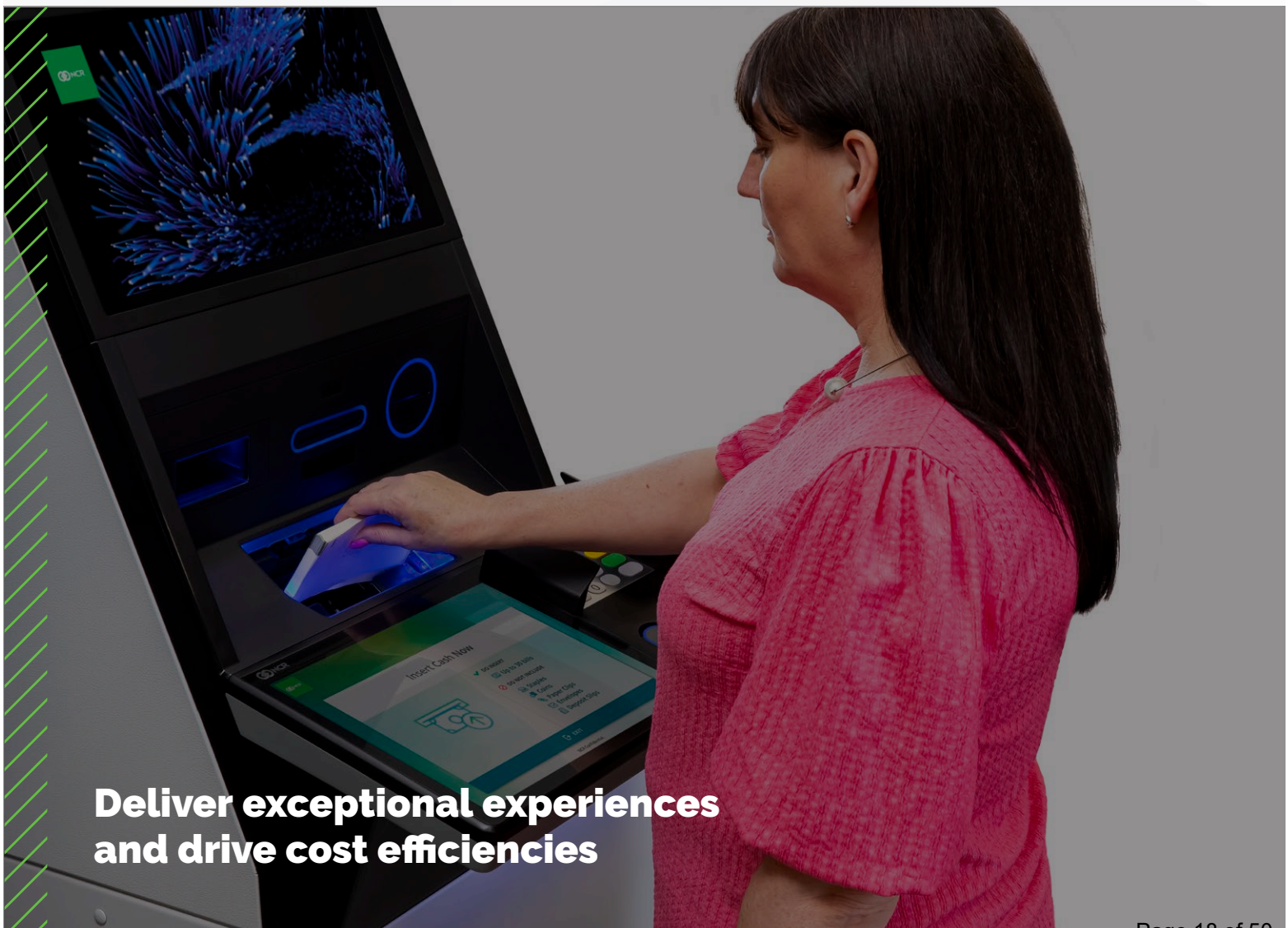

**Deliver exceptional experiences
and drive cost efficiencies**

NCR SelfServ™ 64

Exterior Through-The-Wall Cash Recycler

Through the wall cash recycler for any exterior location

Fast and easy installation—Unique adjustable sleeve for any wall fitment, easy replacement of legacy ATMs

Security built in—Split module architecture for robust physical security

Fully weatherized—Designed to withstand severe environmental conditions

Market leading performance—Ensure best in class ATM availability



**Deliver exceptional experiences
and drive cost efficiencies**

Cash Recycling Made Simple

Feel Better



Experience

Digital-first experiences for your customers and staff. Mobile interactions at the forefront coupled with software-driven capabilities.

Reduce Cost



Efficiency

Reduce the cost to serve, couple the latest cash recycling technology with innovative systems and cash management tools.

Do More



Agility

Drive more transactions, faster. Versatile, modular ATM design for ease of service and better consumer experience.

Design Philosophy

Digital First to Digital Only

User Experience

- Designed for privacy
- Simplified, aesthetically pleasing
- Angled screen for digitally infused transactions

Simple Interactions

- Familiar tablet-like interface
- 15" multi-touch display
- Clear progression to additional transactions

Ease of Service

- Internally strong and robust platform
- Introducing digital-first servicing
- Allowing quick and efficient part replacement



NCR SelfServ™ 62

Experience & Efficiency

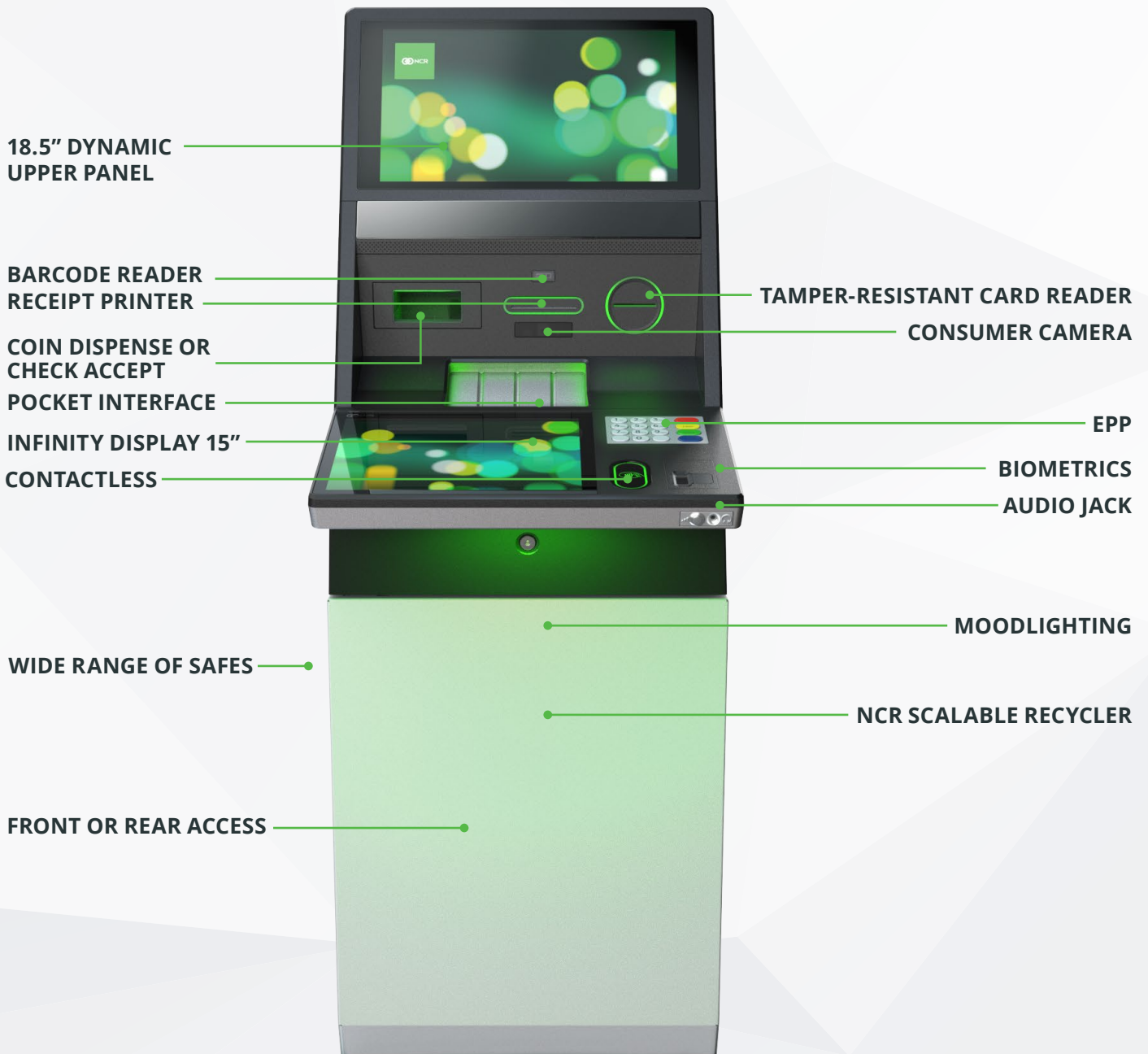

Note: some features are optional

A Transformative Consumer Experience



LARGE CAPACITY
POCKET INTERFACE



PRIMARY CONSUMER INTERACTIONS
15" MULTI-TOUCH SCREEN

ENHANCED BRANDING AND
COLOR CUSTOMIZATION
CAPABILITIES



CONTACTLESS
INTERACTIONS AT
THE FOREFRONT

MOODLIGHTING

NCR SelfServ™ 64

Experience & Efficiency

OPTIONAL ADVERT PANEL —————

EPP —————

TAMPER-RESISTANT CARD READER —————

BARCODE READER —————

RECEIPT PRINTER —————

**COIN DISPENSE OR
CHECK ACCEPT** —————

CONSUMER CAMERA —————

POCKET INTERFACE —————

INFINITY DISPLAY 15" —————

CONTACTLESS CARD READER —————

AUDIO JACK —————

WIDE RANGE OF SAFES —————

NCR SCALABLE RECYCLER —————

MOODLIGHTING —————



Note: some features are optional

NCR Scalable Recycler (SR)— Powering **NCR SelfServ™**

EFFICIENT

- One device common parts
- Improved template support, serviceability, repair & **customer experience**
- Fast media transport
- Market leading bunch capacity

ADAPTABLE

- Meets global market requirements for cash recycling
- **Scalable & flexible**—configurations & options fulfill global market needs.
- Up to 8 denominations recycling
- Pocket media interface

SECURE

- The latest security technology integrated
- **Seamless loading & unloading** of cash from recycler via (un)load option
- **Security by design**—split module enables best-in class physical security architecture



NCR Scalable Recycler (SR)— Device Features

One device; commonality of templates and parts,
improved serviceability, repair, support & customer experience

Pocket interface

up to 300 notes for
dispense and deposit

Exception note handling and separation

3 compartments
(Reject, Retract, CF)

Flexibility

accepts notes,
coupons & vouchers

Transaction speed

10 notes/sec

Scalable

- 3 to 6 cassettes (full & split cassettes)
- up to 8 denominations
- up to 18,300 notes capacity

Cassettes Ink Enabled

in-lid solution, no impact
on capacity

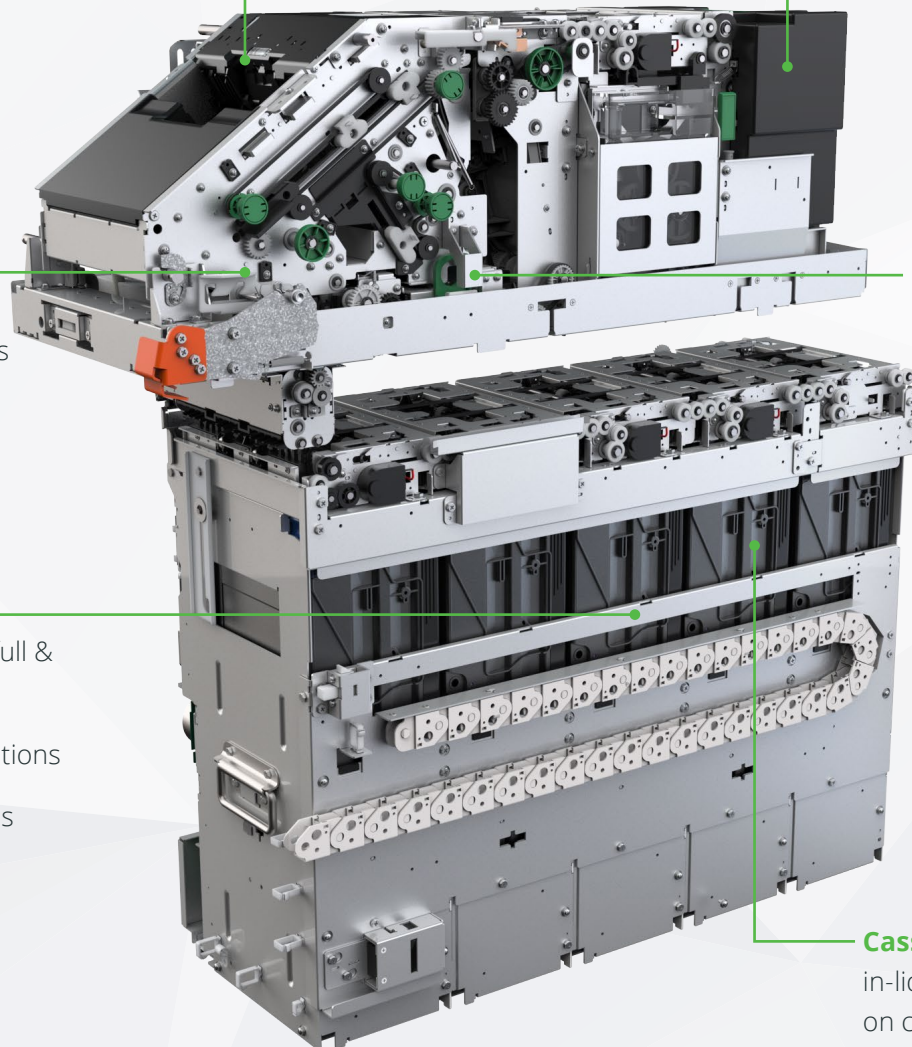



Maximize ROI with software that fully supports cash recycling:

- Fully exploit **cash recycling capabilities** with NCR enterprise ATM Software
- **Optimize cash in and cash out** balance and cash supply costs with NCR Cash Management
- Remove legacy **recycling constraints** with NCR Terminal Handler



Contact us at [NCR.com](https://www.ncr.com) today

Why NCR?

NCR Corporation (NYSE: NCR) is a leader in omni-channel solutions, turning everyday interactions with businesses into exceptional experiences. With its software, hardware, and portfolio of services, NCR enables nearly 700 million transactions daily across retail, financial, travel, hospitality, telecom and technology, and small business. NCR solutions run the everyday transactions that make your life easier.

NCR is headquartered in Atlanta, Ga., with over 30,000 employees and does business in 180 countries. NCR is a trademark of NCR Corporation in the United States and other countries.

NCR Corporation
864 Spring St NW
Atlanta, GA 30308

GENERAL DESCRIPTION

The NCR SelfServ 64 Automated Teller Machine is a 'through the wall' ATM which may be installed through any suitable exterior wall or in a vestibule location.



There are no separate Vestibule or Through the Wall variants of the SelfServ 64. All dimensions and clearances are the same for both types of installation.

Options

Access

- Rear

Standard Security Enclosure

- CEN Grade I

Solid and Gas Explosion Resistant (EX GAS) Security Enclosure

- CEN Grade III
- CEN Grade IV

ACOUSTICS

For most variants the acoustics sound power does not exceed:

- 65 dB(A) when idle
- 68 dB(A) when operating.

However, the following configuration will affect the sound levels as shown in the table below:

Configuration	Acoustic sound power when operating
Coin	does not exceed 72 dB(A)

HEAT DISSIPATION

The NCR SelfServ product range is a flexible hardware platform. NCR recommends that actual power measurements are taken and used to establish the heat dissipation for specific hardware configurations. These measurements should include any custom or third party features.

Where specific measurements are not available then, as a guide, **760 KJ/hour** can be used as an indicative heating load. This figure is based on an ATM in idle mode, with a medium to high feature functionality configuration.

Heat dissipation figures are largely unaffected by transactional rates.

PRODUCT IDENTIFICATION

The illustration below is typical of the layout of the product identification label which is fixed inside the ATM.



The product is identified by a class and a 4 digit model number. The serial number is unique to each ATM. The tracer number is used to identify where the ATM was built.

Please quote all of the serial and tracer numbers, including the prefix, when making reference to the ATM.

Electrical rating information is also shown on the product label.



Fast Ship Program

Get thin brick fast with the METROBRICK® Fast Ship Program. Nine of our most popular colors and seven of our blend options are available in modular size. They ship to your job site fast!

THIN BRICK FAST

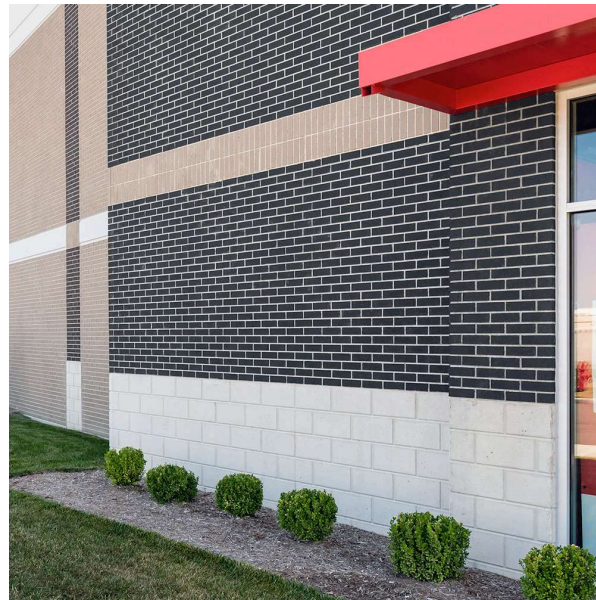

On construction projects, tight deadlines are always an issue. Long lead times often won't work, and anxiously waiting for material is never good. Of course, some delays can't be helped but waiting for thin brick doesn't have to be one. For smaller orders – usually under

10,000 sq. ft. – we created the Fast Ship Program so these color and blend options ship fast to keep you on schedule.

[REQUEST SAMPLES](#)

FAST SHIP SINGLE TONE & RANGE COLOR OPTIONS

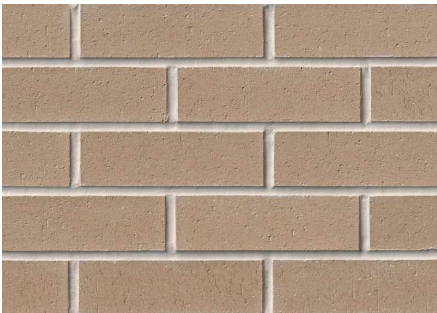

105 FIELDSTONE

Available Texture | Wire
Cut



505 MONUMENT

Available Texture | Smooth
& Wire Cut



507 EMPIRE

Available Texture | Wire
Cut

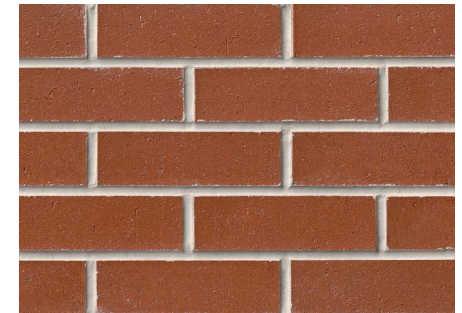

310 MAIN STREET

Available Texture | Wire
Cut

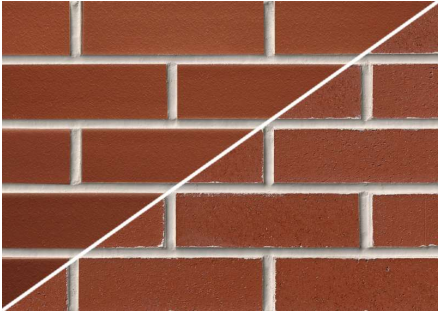

320 SCHOOLHOUSE

Red
Available Texture | Smooth
& Wire Cut

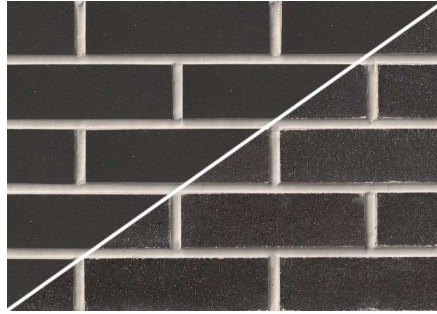

710 CHARCOAL

Available Texture | Smooth
& Wire Cut
(Premium Color)

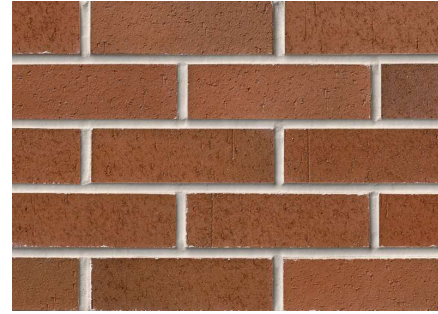

350 MAIN STREET

Flashed
Available Texture | Wire
Cut

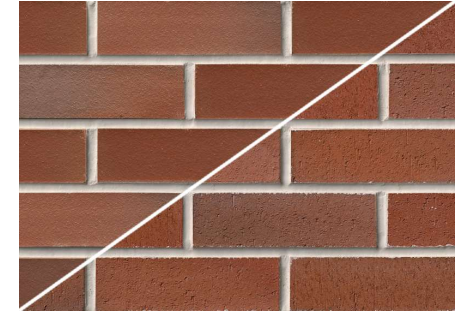

365 SCHOOLHOUSE

Red Flashed
Available Texture | Smooth
& Wire Cut



458 BROWNSTONE

Flashed
Available Texture | Wire
Cut

FAST SHIP BLEND OPTIONS

Lead times may vary.*



FAST SHIP BLEND 1

60% 350 Main Street
Flashed
30% 458 Brownstone
Flashed
10% 710 Charcoal



FAST SHIP BLEND 2

70% 105 Fieldstone
20% 505 Monument
10% 507 Empire



FAST SHIP BLEND 3

90% 458 Brownstone
Flashed
10% 710 Charcoal



FAST SHIP BLEND 4

70% 505 Monument
30% 507 Empire



FAST SHIP BLEND 5

70% 507 Empire
20% 505 Monument
10% 710 Charcoal

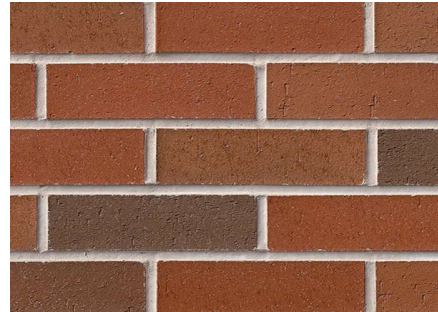

FAST SHIP BLEND 6

50% 350 Main Street
Flashed
30% 310 Main Street
20% 458 Brownstone
Flashed



FAST SHIP BLEND 7

70% 320 Schoolhouse
Red
20% 458 Brownstone
Flashed
10% 710 Charcoal

*For all Fast Ship products, levels of inventory vary. Our ability to fast ship is based on a first-come, first-served basis. Levels of inventoried items will fluctuate. Inventory is designed to assist in quick turnaround for smaller quantity orders – typically under 10,000 sq. ft.

All color swatches are as accurate as digital representations can be. For final color selection, refer to current actual color samples.

AVAILABLE FAST SHIP SHAPES

All Sizes are 5/8" Thick

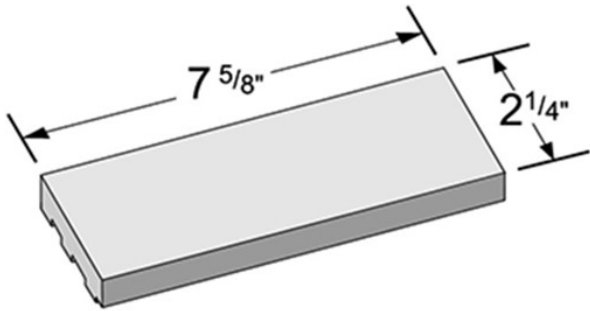

MODULAR

2 1/4" x 7 5/8"

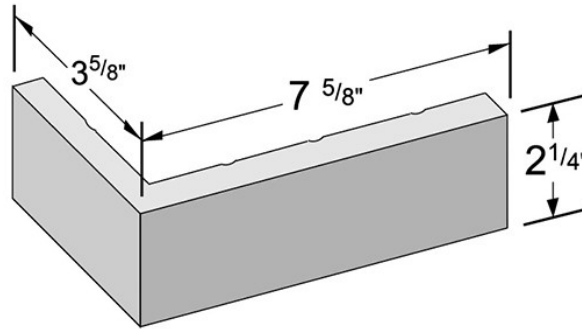

MODULAR CORNER

2 1/4" x 3 5/8" x 7 5/8"

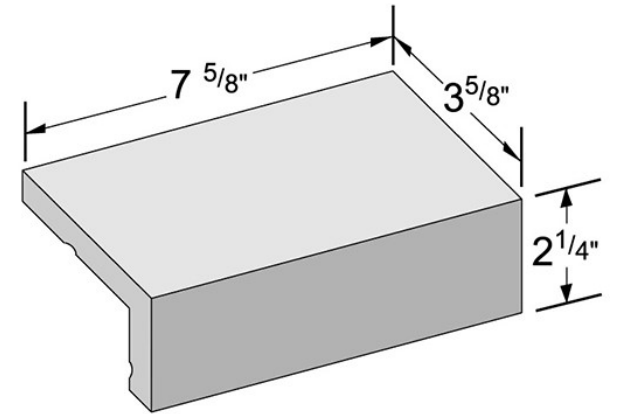

MODULAR EDGE CAP

2 1/4" x 3 5/8" x 7 5/8"

Colors	Smooth	Wire Cut
105 Fieldstone	n/a	✓
458 Brownstone Flashed	n/a	✓
310 Main Street	n/a	✓
350 Main Street Flashed	n/a	✓
320 Schoolhouse Red	✓	✓
365 Schoolhouse Red Flashed	✓	✓
505 Monument	✓	✓
507 Empire	n/a	✓
710 Charcoal (Premium Color)	✓	✓
ALL Color Blends	n/a	✓

TEXTURE OPTIONS

Fast Ship colors are available in Smooth and Wire Cut textures. See chart for details.



FAST SHIP SAMPLES

Interested in samples? Use the button below to request FREE sample materials featuring vital information on METROBRICK's Fast Ship Program.

[REQUEST SAMPLES](#)

PRODUCTS

Blend Generator
Brick Colors
Brick Sizes
Brick Textures
Fast Ship Program
Paint Brick

TECHNICAL

Test Results
PCI Standard
Wax Removal
Warranty

ARCHITECTS

Product Resources
Construction Details

WALL SYSTEMS

Precast Construction
Tilt-Up Construction
Field Applied Mortar Set
Method
Field Applied Wall Panels

PRODUCT GALLERIES

Precast Projects
Tilt-Up Projects
Field Applied Projects
How to Install Thin Brick
Videos

ENVIRONMENTAL

METROBRICK & The
Environment
Thin Brick vs. Full Brick
LEED – USGBC

GET IN TOUCH

info@ironrock.com

1.888.325.3945

1201 Millerton St SE
Canton, OH 44707

STAY CONNECTED





© METROBRICK® 2024 All Rights Reserved | [Privacy Policy](#)

Fabric Awnings & Canopies

Whether for business or home, a fabric awning or canopy can provide protection, create extra space, and enhance the look of a house or storefront. Fabric awnings can achieve a soft look, offer many color options, and allow you the flexibility to change the fabric at a later date. Fabric awnings offer many solutions for windows, doors, entrances, walkways, signage, and patios.

- ✓ 10-Year Framework Warranty
- ✓ Standard Welded Mill Finish Aluminum Frame
- ✓ Powdercoat Optional

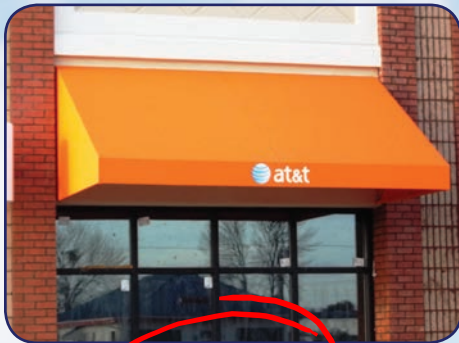

Square



Dome



Convex



A-Frame



Marquee



Stationary Canopy



Elongated Dome



Venetian



Concave

For a FREE Estimate, call 901-368-4477 or visit parasolawnings.com.



Fabric Options

VALANCES



No Valance

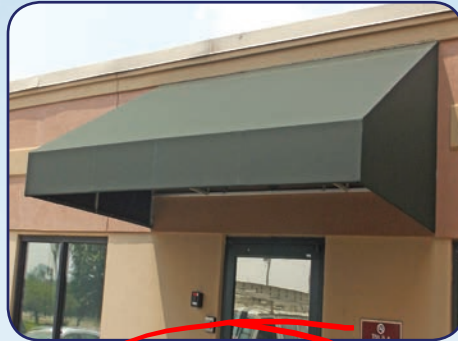

Rigid Valance



Loose Valance

SCALLOPS



Standard



Greek Key



Wave



Straight Hem

ENDS



Closed End



Open End

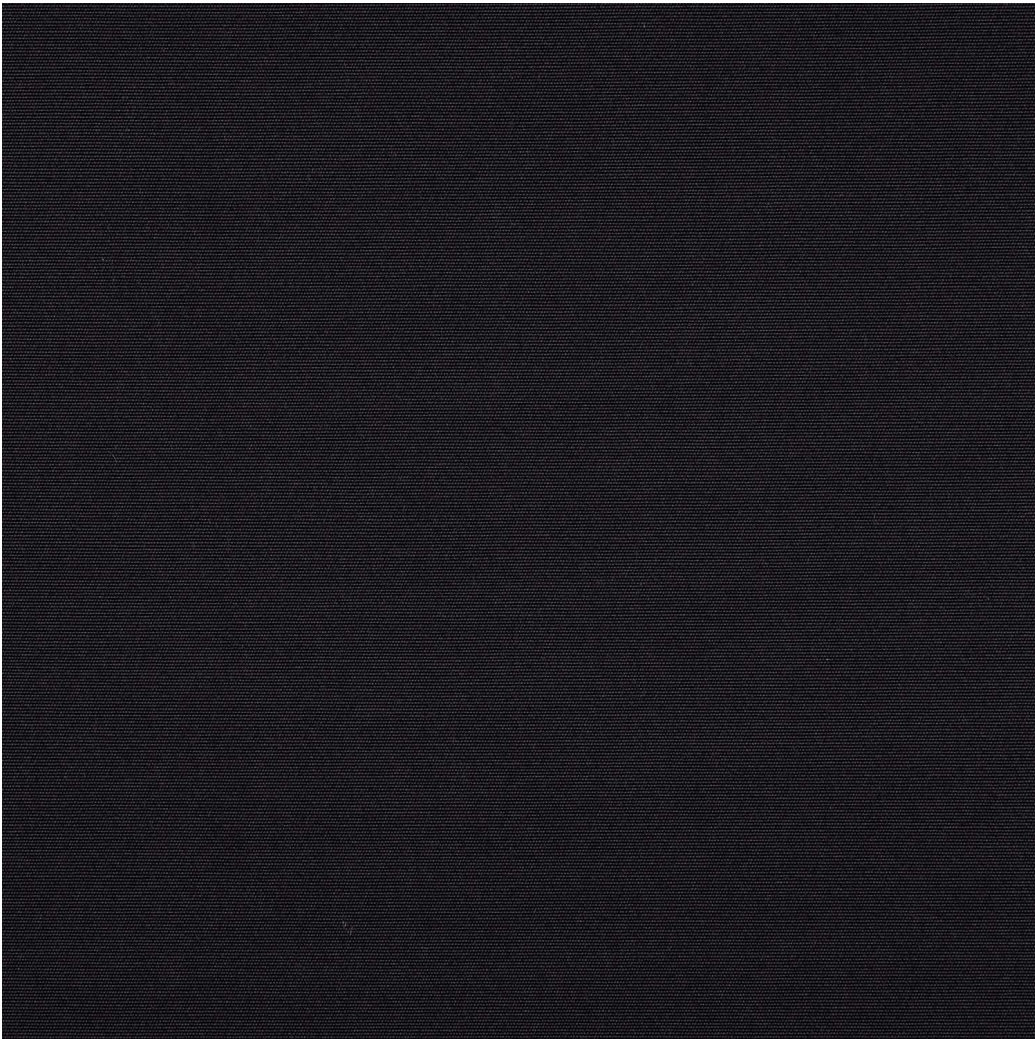

Sunbrella® Awning / Marine 60" Black 6008-0000

Black

Item # 721755

Gain access to pricing, inventory, and online ordering by becoming a customer today.

[Click here to apply!](#)

X

This website uses cookies to better understand how visitors use our site, for advertising, and to offer you a more personalized experience. We share information about your use of our site with third-parties, analytics, social media, and advertising partners in accordance with our [privacy policy](#).

By continuing to use the site, you consent to this use.

OK

commercial awnings, window awnings, patio awnings, RV awnings, and many others!

Sunbrella offers a huge assortment of colors and designs for you to choose from, like this beautiful solid black, as well as a corresponding variety of [Sunbrella upholstery](#) fabrics.

This fabric is made from 100% Sunbrella Acrylic, is heat-sealable with seam seal tape, mildew resistant, water repellent, and meets California Technical Bulletin 117-2013 Class 1 standards.

Warranty: 10 years. Width: 60 inches. Weight: 9 ounces per square yard.

Trademark: Sunbrella® is a registered trademark of Glen Raven, Inc.

Specifications

Heat Sealable:	Yes with Seam Seal Tape	Mildew Resistant:	Yes
Shade Percent:	99.99% (<0.01% openness factor)	Color:	Black
Base Fabric:	100% Sunbrella® Acrylic	Finish/Coating:	Water Repellent
Product Category:	Sunbrella Awning / Marine 60 in. Solids	Government Specifications Met:	None

X

This website uses cookies to better understand how visitors use our site, for advertising, and to offer you a more personalized experience. We share information about your use of our site with third-parties, analytics, social media, and advertising partners in accordance with our [privacy policy](#).

By continuing to use the site, you consent to this use.

Width:	60 in.		
Pattern Direction:	Up the Roll, Selvedge is Left / Right		
Shrinkage Factor:	None		
Standard Package:	60 yd.		
Underside Color:	Same		

X

This website uses cookies to better understand how visitors use our site, for advertising, and to offer you a more personalized experience. We share information about your use of our site with third-parties, analytics, social media, and advertising partners in accordance with our [privacy policy](#).

By continuing to use the site, you consent to this use.

DESCRIPTION

The Entri LED luminaire features a classic and stylish design with the added benefits of solid state lighting technology, offering outstanding uniformity and energy savings. Using Cooper Lighting Solutions' proprietary LED LightSquare technology and AccuLED Optics™ system, the Entri LED luminaire offers designers vast versatility in system design, function and performance. Use Entri LED for wall mount architectural lighting applications and egress lighting requirements. UL/cUL listed for use in wet locations.

Catalog #		Type	
Project			
Comments		Date	
Prepared by			

SPECIFICATION FEATURES

Construction

HOUSING: Heavy wall, one-piece, die-cast aluminum construction for precise tolerance control and repeatability in manufacturing. Integral extruded aluminum heat sink provides superior thermal heat transfer in +40°C ambient environments. **FACEPLATE / DOOR:** One-piece, die-cast aluminum construction. Captive, side hinged faceplate swings open via release of one flush mount die-cast aluminum latch on housing side panel. **GASKET:** One-piece molded silicone gasket mates perfectly between the door and housing for repeatable seal. **LENS:** Uplight lens is impact-resistant, 5/32" thick tempered frosted glass sealed to housing with continuous bead silicone gasket. Downlight lens is an LED LightSquare with integral optics sealed for IP66 rating. **HARDWARE:** Stainless steel mounting screws and latch hardware allow access to electrical components for installation and servicing.

Optics

Choice of 9 patented, high efficiency AccuLED Optics™ distributions. Optics are precisely designed to shape the light output, maximizing efficiency and application spacing. AccuLED Optics technology creates consistent distributions with the

scalability to meet customized application requirements. CRI and CCT offering includes 2200K, 2700K, 3000K, 3500K, 4000K, 5000K, and 5700K with minimum 70CRI and 2700K and 3000K with minimum 80CRI all within 5-step MacAdam ellipse.

Electrical

LED drivers mount to die-cast aluminum back housing for optimal heat sinking, operation efficacy, and prolonged life. Standard drivers feature electronic universal voltage (120-277V 50/60Hz), 347V 60Hz or 480V 60Hz operation. 480V is compatible for use with 480V Wye systems only. Greater than 0.9 power factor, less than 20% harmonic distortion, and is suitable for operation in -40°C to 40°C ambient environments and optional 50C construction available. All fixtures are shipped standard with 10kV/10kA common – and differential – mode surge protection. LightSquare feature an IP66 enclosure rating and maintain greater than 98% lumen maintenance at 60,000 hours per IESNA TM-21. Emergency egress options for -20°C ambient environments, WaveLinX™, occupancy sensor, and dimming options available.

Mounting

JUNCTION BOX: Standard with

zinc-plated, quick-mount junction box plate that mounts directly to 4" J-Box. LightSquare mounts facing downward. Fixture slides over mounting plate and is secured with two stainless steel fasteners. Mounting plate features a one-piece EPDM gasket on back side of plate to firmly seal fixture to wall surface, forbidding entry of moisture and particulates. Optional mounting arrangements utilize a die-cast mounting adaptor box to allow for LED battery pack, surface conduit and trough branch wiring. The Entri LED luminaire is approved for mounting on combustible surfaces.

Finish

Housing is finished in five-stage super TGIC polyester powder coat paint, 2.5 mil nominal thickness for superior protection against fade and wear. LightSquare cover plates are standard white and may be specified to match finish of luminaire housing. Standard colors include black, bronze, grey, white, dark platinum and graphite metallic. RAL and custom color matches available. Consult Outdoor Architectural Colors brochure for a complete selection.

Warranty

Five year limited warranty, consult website for details.
www.cooperlighting.com/legal



ENC/ENT/ENV ENTRI LED

LightSquare
Solid State LED

ARCHITECTURAL WALL
LUMINAIRE



CERTIFICATION DATA

DesignLights Consortium® Qualified*
UL/cUL Listed
ISO 9001
IP66 LightSquares
LM79 / LM80 Compliant

ENERGY DATA

Electronic LED Driver
>0.9 Power Factor
<20% Total Harmonic Distortion
120-277V/50 & 60Hz, 347V/60Hz, 480V/60Hz
-30°C Minimum Temperature
40°C Ambient Temperature Rating (Optional)

SHIPPING DATA

Approximate Net Weight:
15.2 lbs. (6.9 kgs.) - Without backbox
29.1 lbs. (13.2 kgs.) - With backbox

DIMENSIONS

ENC (Round Clean)

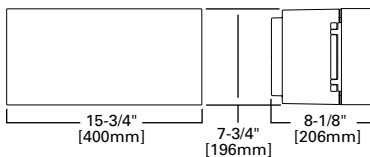

ENT (Triangle Reveals)

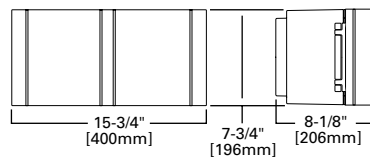

ENV (Round Reveals)

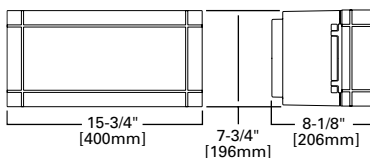

CONDUIT MOUNT / BATTERY BACK BOX

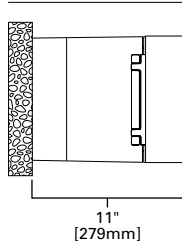

ORDERING INFORMATION

Sample Number: ENC-SA1C-740-U-T4W-GM-ULG-HA-WPS2BK

Domestic Preferences ²⁴	Product Family ¹	Light Engine		Color Temperature	Voltage	Distribution	Finish
		Configuration	Drive Current				
[Blank]=Standard BAA=Buy American Act TAA=Trade Agreements Act	ENC=Entri Round Clean ENT=Entri Triangle Reveals ENV=Entri Round Reveals	SA1=1 Square	A=350mA B=450mA C=600mA D=800mA E=1000mA F=1200mA	722=70CRI, 2200K ³ 727=70CRI, 2700K ³ 730=70CRI, 3000K ³ 735=70CRI, 3500K 740=70CRI, 4000K 750=70CRI, 5000K ³ 760=70CRI, 5700K ³ 827=80CRI, 2700K ³ 830=80CRI, 3000K ³ 835=80CRI, 3500K ³	U=UNV (120-277) 1=120 2=208 3=240 4=277 8=480 9=347	T2=Type II T3=Type III T4FT=Type IV Forward Throw T4W=Type IV Wide SL2=Type II w/Spill Control SL3=Type III w/Spill Control SL4=Type IV w/Spill Control SLL=90° Spill Light Eliminator Left SLR=90° Spill Light Eliminator Right	BZ=Bronze AP=Grey BK=Black DP=Dark Platinum GM=Graphite Metallic WH=White
Options (Add as Suffix) F=Singled fused (Must specify voltage, fused on single hot leg of 120, 277, or 347) FF=Doubled fused (Must specify voltage, fused on both hot legs of 208, 240, or 480) X=Driver Surge Protection (6kV) Only 20K=Series 20kV UL 1449 Surge Protective Device 2L=Two-Circuit Light Engine ²³ DIM=0-10V Dimming Driver ^{5,6} EBP=Battery Pack with Back Box (Must specify voltage, available in 120V or 277V) ^{2,4,9} CBP=Battery Pack with Back Box, Cold Weather Rated (Must specify voltage, available in 120V or 277V) ^{2,4,10} CBP-CEC=Battery Pack with Back Box, Cold Weather Rated, CEC compliant (Must specify voltage, available in 120V or 277V) ^{2,4,10} R90=Rotated Right 90° L90=Rotated Left 90° HSS=Factory Installed House Side Shield ¹⁶ LCF=LightSquare Trim Plate Matches Housing Finish ¹⁵ ULG=Uplight Glow ⁷ HA=50°C High Ambient ⁸ WG=Wire Guard TR=Tamper Resistant Hardware BOX=Empty back box (1/2" NPT, each side with plugs installed) BPC=Button Type Photocontrol (Must specify voltage, available in 120, 208, 240, 277V, 347, and 480) AHD145=After Hours Dim, 5 Hours, 50% ¹⁷ AHD245=After Hours Dim, 6 Hours, 50% ¹⁷ AHD255=After Hours Dim, 7 Hours, 50% ¹⁷ AHD355=After Hours Dim, 8 Hours, 50% ¹⁷ SPB1=Dimming Occupancy Sensor with Bluetooth Interface, <8' Mounting ^{13,21} SPB2=Dimming Occupancy Sensor with Bluetooth Interface, 8'-20' Mounting ^{13,21} SPB4=Dimming Occupancy Sensor with Bluetooth Interface, 21'-40' Mounting ^{13,21} MS-L08=Motion Sensor for ON/OFF Operation, Up to 8' Mounting Height ^{11,12,13} MS-L20=Motion Sensor for ON/OFF Operation, 9' - 20' Mounting Height ^{11,12,13} MS/DIM-L08=Motion Sensor for Dimming Operation, Up to 8' Mounting Height ^{11,12,13} MS/DIM-L20=Motion Sensor for Dimming Operation, 9' - 20' Mounting Height ^{11,12,13} WPS2XX=WaveLinX Pro, SR Driver, Dimming Motion and Daylight, WAC Programmable, 7' - 15' Mounting ^{19,20} WPS4XX=WaveLinX Pro, SR Driver, Dimming Motion and Daylight, WAC Programmable, 15' - 40' Mounting ^{19,20} CC=Coastal Construction ²²				Accessories (Order Separately) ²⁵ MA1253=10kV Circuit Module Replacement MA1253-480V=10kV Circuit Module Replacement (480V only) FSIR-100-PK=Wireless Configuration Tool for Occupancy Sensor ¹¹ VA6172SA=Wireguard Accessory VA6173=Tamper-Resistant Driver Bit VA6174=Vandal Shield Accessory VA2001-XX=Thru-Way Conduit Box LS/HSS=House Side Shield (Works with all distributions listed for Entri) WOLC-7P-10A=WaveLinX Outdoor Control Module (7-pin)			

NOTES:

- DesignLights Consortium® Qualified. Refer to www.designlights.org Qualified Products List under Family Models for details. DLC Family Code: MMMSPQ
- EBP or CBP options limited to 25°C. Control option limited to BPC=Button Type Photocontrol (must specify voltage).
- Extended lead times apply. Use dedicated IES files when performing layouts.
- Not available with HA option.
- Cannot be used with other control options.
- Low voltage control lead brought out 18" outside fixture.
- ULG only available in 740
- Not available with ULG option
- EBP is rated for minimum operating temperature of 0°C (32°F). Operates downlight for 90-minutes.
- CBP is rated for minimum operating temperature of -20°C (-4°F). Operates downlight for 90-minutes.
- The FSIR-100 configuration tool is required to adjust parameters including high and low modes, sensitivity, time delay, cutoff and more. Consult your lighting representative at Cooper Lighting
- Replace LXX with the available mounting height options: L08, L20, L40 or L40W are the only choices.
- Includes integral photosensor.
- Bronze sensor is shipped with Bronze fixtures. White sensor shipped on all other housing color options.
- Not available with HSS option.
- Only for use with SL2, SL3 and SL4 distributions. The light square trim plate is painted black when the HSS option is selected.
- Requires the use of BPC photocontrol. See After Hours Dim supplemental guide for additional information.
- Control option limited to BPC=Button Type Photocontrol (must specify voltage).
- WAC Gateway required to enable field-configurability: Order WAC-PoE and WPOE-120 (10V to PoE injector) power supply if needed.
- Replace XX with sensor color (WH, BZ, or BK).
- Smart device with mobile application required to change system defaults. See controls section for details.
- Coastal construction finish salt spray tested to over 5,000-hours per ASTM B117, with a scribe rating of 9 per ASTM D1654.
- 2L not available with FF, ULG or AHD options. Controls and/or battery packs operate only one of the two circuits when 2L is specified.
- Only product configurations with these designated prefixes are built to be compliant with the Buy American Act of 1933 (BAA) or Trade Agreements Act of 1979 (TAA), respectively. Please refer to [DOMESTIC PREFERENCES](#) website for more information. Components shipped separately may be separately analyzed under domestic preference requirements.
- Accessories sold separately will be separately analyzed under domestic preference requirements. Consult factory for further information.

POWER AND LUMENS

1 LightSquare (SA Series)		ENC (Entri - Round Clean) / ENT (Entri - Triangle Reveals) / ENV (Entri - Round Reveals)							
Drive Current (mA)		EBP / CBP	SA1A (350mA)	SA1B (450mA)	SA1C (600mA)	SA1D (800mA)	SA1E (1000mA)	SA1F (1200mA)	
Power (Watts)	120-277V±	13	20.1	25.4	33.3	43.1	57.2	66.1	
Current (A)	120V	--	0.17	0.22	0.29	0.38	0.48	0.56	
	277V	--	0.09	0.1	0.13	0.17	0.21	0.25	
Power (Watts)	347V or 480V	--	23.3	28.7	36.6	49.5	60.7	70.1	
Current (A)	347V	--	0.07	0.08	0.11	0.15	0.18	0.21	
	480V	--	0.05	0.06	0.08	0.11	0.13	0.16	
Optics									
730 CCT	T4W (Type IV Wide)	Lumens	703	2,489	3,122	4,108	5,141	6,406	7,090
		Lumens per Watt [†]	54.1	123.8	122.9	123.4	119.3	112.0	107.3
		BUG Rating	B0-U0-G0	B1-U0-G1	B1-U0-G1	B1-U0-G1	B1-U0-G1	B1-U0-G2	B1-U0-G2
	T4W-HSS (Type IV Wide, House Side Shield)	Lumens	524	1,857	2,328	3,064	3,835	4,778	5,288
		Lumens per Watt [†]	40.3	92.4	91.7	92.0	89.0	83.5	80.0
		BUG Rating	B0-U0-G0	B0-U0-G1	B0-U0-G1	B0-U0-G1	B0-U0-G1	B1-U0-G2	B1-U0-G2
	SL2 (Type II w/Spill Control)	Lumens	694	2,459	3,084	4,058	5,079	6,328	7,004
		Lumens per Watt [†]	53.4	122.3	121.4	121.9	117.8	110.6	106.0
		BUG Rating	B0-U0-G0	B1-U0-G1	B1-U0-G1	B1-U0-G1	B1-U0-G2	B1-U0-G2	B2U0-G2
	SL2-HSS (Type II w/Spill Control, House Side Shield)	Lumens	568	2,012	2,524	3,321	4,156	5,178	5,732
		Lumens per Watt [†]	43.7	100.1	99.4	99.7	96.4	90.5	86.7
		BUG Rating	B0-U0-G0	B0-U0-G1	B1-U0-G1	B1-U0-G1	B1-U0-G1	B1-U0-G2	B1-U0-G2
	SL3 (Type III w/Spill Control)	Lumens	690	2,442	3,063	4,030	5,044	6,285	6,956
		Lumens per Watt [†]	53.1	121.5	120.6	121.0	117.0	109.9	105.2
		BUG Rating	B0-U0-G0	B1-U0-G1	B1-U0-G1	B1-U0-G1	B1-U0-G2	B1-U0-G2	B1-U0-G2
	SL3-HSS (Type III w/Spill Control, House Side Shield)	Lumens	589	2,086	2,616	3,442	4,308	5,368	5,941
		Lumens per Watt [†]	45.3	103.8	103.0	103.4	100.0	93.8	89.9
		BUG Rating	B0-U0-G0	B0-U0-G1	B0-U0-G1	B1-U0-G1	B1-U0-G1	B1-U0-G2	B1-U0-G2
	SL4 (Type IV w/Spill Control)	Lumens	666	2,361	2,960	3,895	4,875	6,074	6,723
		Lumens per Watt [†]	51.2	117.5	116.5	117.0	113.1	106.2	101.7
		BUG Rating	B0-U0-G0	B0-U0-G1	B1-U0-G1	B1-U0-G1	B1-U0-G2	B1-U0-G2	B1-U0-G2
	SL4-HSS (Type IV w/Spill Control, House Side Shield)	Lumens	577	2,043	2,562	3,371	4,219	5,257	5,818
		Lumens per Watt [†]	44.4	101.6	100.9	101.2	97.9	91.9	88.0
		BUG Rating	B0-U0-G0	B0-U0-G1	B0-U0-G1	B0-U0-G1	B1-U0-G1	B1-U0-G2	B1-U0-G2
SLR (90° Spill Light Eliminator Right)	Lumens	622	2,201	2,761	3,633	4,547	5,665	6,270	
	Lumens per Watt [†]	47.8	109.5	108.7	109.1	105.5	99.0	94.9	
	BUG Rating	B0-U0-G0	B1-U0-G1	B1-U0-G1	B1-U0-G1	B1-U0-G1	B1-U0-G2	B1-U0-G2	
SLR-HSS (90° Spill Light Eliminator Right, House Side Shield)	Lumens	529	1,872	2,347	3,089	3,866	4,817	5,331	
	Lumens per Watt [†]	40.7	93.1	92.4	92.8	89.7	84.2	80.7	
	BUG Rating	B0-U0-G0	B0-U0-G1	B0-U0-G1	B1-U0-G1	B1-U0-G1	B1-U0-G1	B1-U0-G1	
SLL (90° Spill Light Eliminator Left)	Lumens	622	2,201	2,761	3,633	4,547	5,665	6,270	
	Lumens per Watt [†]	47.8	109.5	108.7	109.1	105.5	99.0	94.9	
	BUG Rating	B0-U0-G0	B1-U0-G1	B1-U0-G1	B1-U0-G1	B1-U0-G1	B1-U0-G1	B1-U0-G2	
SLL-HSS (90° Spill Light Eliminator Left, House Side Shield)	Lumens	529	1,872	2,347	3,089	3,866	4,817	5,331	
	Lumens per Watt [†]	40.7	93.1	92.4	92.8	89.7	84.2	80.7	
	BUG Rating	B0-U0-G0	B0-U0-G1	B1-U0-G1	B1-U0-G1	B1-U0-G1	B1-U0-G1	B1-U0-G1	
735 CCT	T2 (Type II)	Lumens	722	2,556	3,205	4,218	5,279	6,577	7,279
		Lumens per Watt [†]	55.5	127.2	126.2	126.7	122.5	115.0	110.1
		BUG Rating	B0-U0-G0	B1-U0-G1	B1-U0-G1	B1-U0-G1	B1-U0-G1	B1-U0-G2	B1-U0-G2
	T2-HSS (Type II, House Side Shield)	Lumens	549	1,943	2,437	3,207	4,013	5,000	5,535
		Lumens per Watt [†]	42.2	96.7	95.9	96.3	93.1	87.4	83.7
		BUG Rating	B0-U0-G0	B0-U0-G1	B0-U0-G1	B0-U0-G1	B0-U0-G1	B0-U0-G1	B1-U0-G2

LUMEN MAINTENANCE

SA1 (All Drive Currents)					
Hours	25,000 hours*	50,000 hours*	60,000 hours*	100,000 hours**	Theoretical L70 (Hours)**
25 °C	99.4%	99.0%	98.9%	98.3%	2,471,000
40 °C	99.4%	99.0%	98.9%	98.3%	2,471,000
50 °C	99.4%	99.0%	98.9%	98.3%	2,471,000

* Supported by IES TM-21 standards

** Theoretical values represent estimations commonly used; however, refer to the IES position on LED Product Lifetime Prediction, IES PS-10-18, that explains proper use of IES TM-21 and LM-80.

LUMEN MULTIPLIER

Ambient Temperature	SA1 (All Drive Currents)
0 °C	1.02
10 °C	1.01
25 °C	1.00
40 °C	0.99
50 °C	0.97

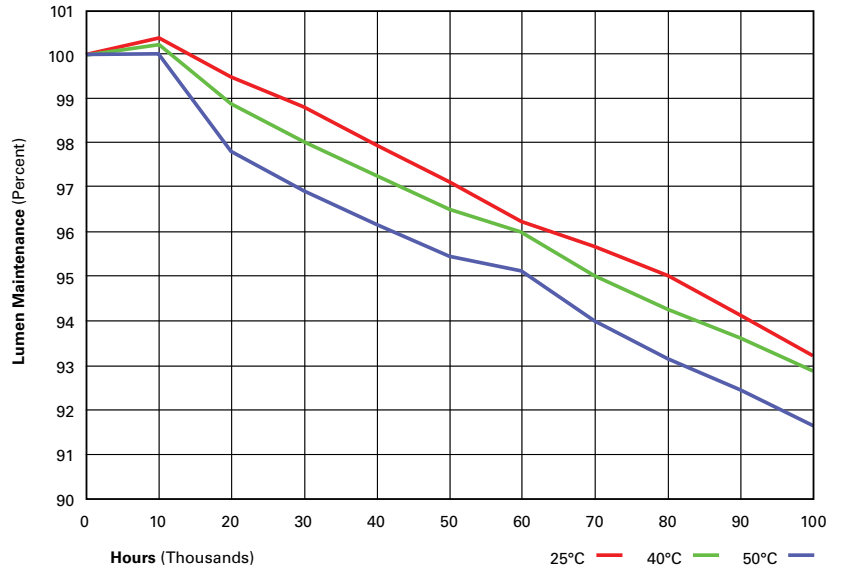

CRESCENT STREET

CONCEPT KIOSK LAYOUT OPTION #1

OBJECTIVE: FACILITATE ACCESSIBILITY COMPLIANCE FOR SAFE-HARBOR LANDING AT ATM KIOSK, NOT TO EXCEED 2% GRADE BOTH PERPENDICULARLY AND PARALLEL TO PROPOSED ATM KIOSK OPERATION / CONTROLS.

EXISTING ALCOVE DOES NOT CURRENTLY MEET FORWARD APPROACH REQUIREMENT NOT TO EXCEED 5% GRADE, EXCEEDING 6%; AND RENOVATION TO BUILDING AREA WILL REQUIRE BRINGING THIS - AND POTENTIALLY OTHER AREAS INTO COMPLIANCE.

THE BELOW PROPOSED SOLUTION IS NOT ADVISABLE DUE TO THE SIGNIFICANT STRUCTURAL MODIFICATION REQUIRED.

- DEMOLISH CONCRETE LANDING AT EXTERIOR SIDE OF ENTRY ALCOVE.
- NEW CONCRETE LANDING AT EXTERIOR SIDE OF ALCOVE, WITH RAISED EDGE AT SIDEWALK ADJACENT TO ATM KIOSK, LIP MAY EXCEED 3.5" AND A GUARD RAIL MAY BE REQUIRED BY AHJ. PAD TO PROVIDE 2% MAX. SLOPE IN EITHER DIRECTION AT 32"x48" CLEAR SPACE ADJACENT TO KIOSK.
- CONCRETE LANDING TO PROVIDE 5% MAX. SLOPE FROM SIDEWALK TO ENTRY DOOR; MODIFICATION TO DOOR SILL REQUIRED.
- NEW SINGLE PANEL ENTRY DOOR.
- NEW INTERIOR PARTITIONS TO CREATE ATM SERVICE CLOSET.
- MODIFY EXTERIOR ENTRY DOOR WALL, STRUCTURAL TEMPORARY BRACING REQUIRED
- NEW INTERIOR FINISHES AT BUILDING INTERIOR VESTIBULE (EXTENT BEYOND REPLACED STRUCTURAL PLANKS).

THIS DESIGN WOULD PROVIDE REQUIRED ACCESSIBLE SLOPES AT ENTRY DOOR AND ATM KIOSK, BUT MAY REQUIRE ACCESSIBILITY CODE HARDSHIP / EXCEPTIONS FOR ACCESSIBLE PATH OF TRAVEL.

TIMELINE:

COMPLETED:

- JULY 2023 INITIAL SUBMITTAL - REJECTED NEEDING CURRENT PLAT.
- SURVEY RCVD AND RESUBMITTED NOVEMBER 2023.
- INITIAL REMARKS & RESUBMIT FEBRUARY 2024.
- FULL REMARKS RECEIVED LATE MARCH 2024; RESUBMIT EARLY JUNE 2024.
- ROUND 2 FULL REMARKS RECEIVED, REVISED AND RESUBMITTED JULY 2024.
- VILLAGE CANCELLED THE AUG 2024 COMMISSION MEETING.
- ALL ITEMS REQUESTED BY VILLAGE SUBMITTED FOR SEPT. COMMISSION SENT BY PMDG, REPRESENTATION BY STRATUS UNLIMITED. COMMISSION DETERMINED MORE INFO IS NEEDED.
- COORDINATED FOR PM DESIGN REPRESENTATION AT NOVEMBER MEETING.
- AAC REQUESTED ALTERNATE DESIGN, DOES NOT LIKE REMOVAL OF WINDOW(S).

ESTIMATED REMAINING:

- PLANNING PROCESS: 16-20 WEEK*
- ARCHITECTURAL / STRUCTURAL SURVEY AND ANALYSIS: 4-6 WEEK
- DESIGN AND DOCUMENTATION: 3-4 WEEK
- PERMIT PROCESS: 4-6 WEEK*

*APPROXIMATION PER INITIAL DUE DILIGENCE, AND 1 ROUND OF REMARK(S)

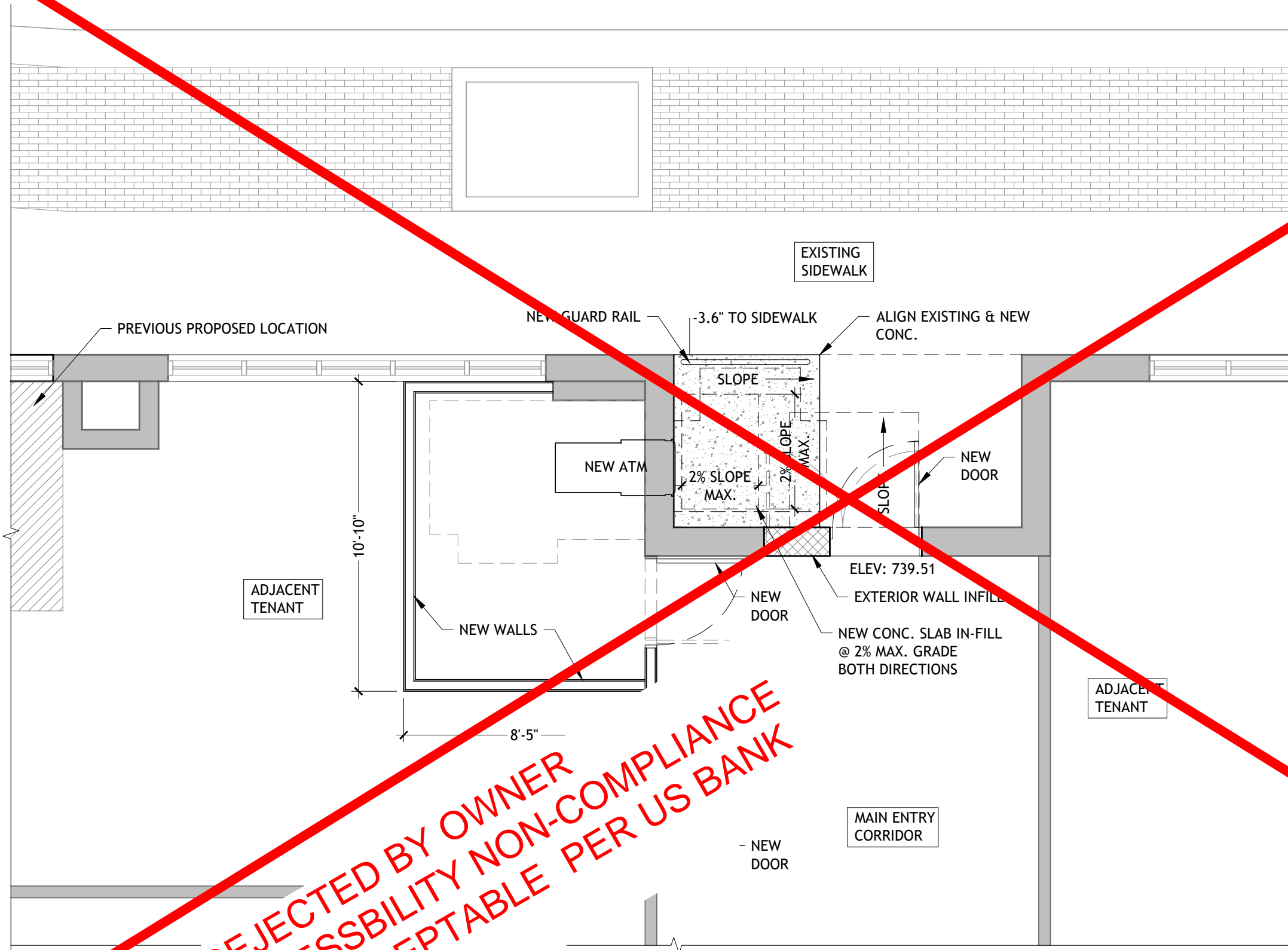

**REJECTED BY OWNER
ACCESSIBILITY NON-COMPLIANCE
NOT ACCEPTABLE PER US BANK
STANDARDS**



**US BANK WALL MOUNTED ATM
515 CRESCENT BLVD
PROPOSED PLAN 1**

NFC SCALE: 1/4" = 1'-0"
 DRWN BY: PJO
 DATE: 1/26/2025
 NORTH
1